

MEDLEY PARK STORMWATER IMPROVEMENT

CITY OF GOLDEN VALLEY

GOLDEN VALLEY, MN

CITY PROJECT #20-26

Item 5A.
BCWMC 5-19-22

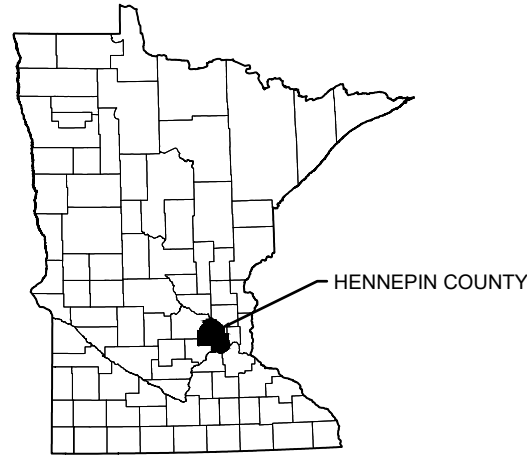

MINNESOTA COUNTY MAP



PROJECT LOCATION MAP



0 100 200
SCALE IN FEET

INDEX OF SHEETS

G-01	TITLE SHEET AND SITE LOCATION MAP
G-02	STATEMENT OF ESTIMATED QUANTITIES
C-01	EXISTING CONDITIONS, PED/TRAFFIC CONTROL, & EROSION CONTROL REMOVALS
C-02	GRADING AND STORM SEWER PLAN
C-03	PONDS AND STORM SEWER PROFILES
C-04	STREAM AND BERM OVERFLOW PLAN, PROFILE & SECTION
C-05	EMERGENCY OVERFLOW DETAILS
C-06	BITUMINOUS TRAIL PAVING PLAN
C-07	BITUMINOUS TRAIL PAVING PROFILES
C-08	DETAILS - STORM SEWER
C-09	DETAILS - BITUMINOUS TRAIL, CONCRETE PAD, AND BENCH
C-10	DETAILS - SITE FEATURES
C-11	TEMPORARY WINTER EROSION CONTROL
C-12	
SW-01	STORMWATER POLLUTION PREVENTION PLAN (SWPPP)
SW-02	STORMWATER POLLUTION PREVENTION PLAN (SWPPP)
SW-03	EROSION & SEDIMENT CONTROL DETAILS
SW-04	EROSION & SEDIMENT CONTROL DETAILS
L-01	LANDSCAPE PLANTING PLAN
L-02	LANDSCAPE PLAN AND DETAILS
B-01	SOIL BORING LOGS

PROJECT CONTACTS:

KATIE TURPIN-NAGEL, PE
BARR ENGINEERING CO.
PHONE: 952-842-3690
FAX: 952-832-2601
EMAIL: KJN2@BARR.COM

JEFF OLIVER, PE
CITY OF GOLDEN VALLEY
PHONE: 763-593-8034
EMAIL: JOLIVER@GOLDENVALLEYMN.GOV

KURT LEUTHOLD, PE
BARR ENGINEERING CO.
PHONE: 952-832-2859
FAX: 952-832-2601
EMAIL: KAL@BARR.COM

ERIC ECKMAN
CITY OF GOLDEN VALLEY
PHONE: 763-593-8084
EMAIL: EECKMAN@GOLDENVALLEYMN.GOV

COORDINATE SYSTEM: HENNEPIN COUNTY
HORIZONTAL DATUM: NAD83 (2011)
VERTICAL DATUM: NAVD88



GOPHER STATE ONE CALL:
CALL BEFORE YOU DIG.
1-800-252-1166

I HEREBY CERTIFY THAT THIS PLAN WAS PREPARED BY ME OR UNDER MY DIRECT SUPERVISION AND THAT I AM A DULY LICENSED PROFESSIONAL ENGINEER UNDER LAWS OF THE STATE OF MINNESOTA.

JEFF OLIVER, PE, CITY ENGINEER
DATE: _____ REG. NO. 23110

90% DESIGN
NOT FOR CONSTRUCTION

				I HEREBY CERTIFY THAT THIS PLAN, SPECIFICATION, OR REPORT WAS PREPARED BY ME OR UNDER MY DIRECT SUPERVISION AND THAT I AM A DULY LICENSED PROFESSIONAL ENGINEER UNDER LAWS OF THE STATE OF MINNESOTA.				CLIENT 2/10/21 4/22/22				Scale AS SHOWN				BARR PROJECT No. 23/27-1901.00							
				PRINTED NAME				CONSTRUCTION				Date 04/22/2022				CLIENT PROJECT No. 20-26							
				SIGNATURE				RELEASED TO/FOR				Checked KJN2				DWG. No. G-01							
				DATE				DATE RELEASED				Designed BARR				REV. No. B							
				LICENSE #								Approved KAL											
NO.				BY				CHK				APP				DATE				REVISION DESCRIPTION			
B				GGN				KJN2				KAL				04/22/2022				ISSUED FOR 90% DESIGN REVIEW			
A				ADB2				KJN2				KAL				12/10/2021				ISSUED FOR REVIEW			

CADD USER: Greg Nelson FILE: I:\DESIGN\23271901_00\3271901_001_TITLESHEET.DWG PLOT SCALE: 1:2 PLOT DATE: 4/22/2022 4:04 PM

Corporate Headquarters:
Minneapolis, Minnesota
Ph: 1-800-632-2277

CITY OF GOLDEN VALLEY
GOLDEN VALLEY, MN

MEDLEY PARK
STORMWATER IMPROVEMENT

TITLE SHEET AND
SITE LOCATION MAP

STATEMENT OF ESTIMATED QUANTITIES				
LINE	ITEM NO.	ITEM DESCRIPTION	UNITS	TOTAL ESTIMATED QUANTITY
1		Mobilization	LS	1
2		Traffic and Pedestrian Safety Control Measures	LS	1
3		Construction Layout and Staking	LS	1
4		Remove and Dispose Electrical Conduit, Light Poles, and Fixtures	LS	1
5		Dewatering	LS	1
6		Silt Fence, Machine Sliced (P)	LF	1,622
7		Storm Drain Inlet Protection (P)	EA	5
8		Flotation Silt Curtain, Light Duty (P)	LF	40
9		Tree Protection Fencing	LF	585
10		Stabilized Construction Entrance	EA	1
11		Daily Street Sweeping	LS	1
12		Clearing and Grubbing Trees/Shrubs less than 8" Diameter	LS	1
13		Removal and Disposal of Tree Stump 12 inch to 24 inch Diameter	EA	5
14		Removal and Disposal of Tree 32 inch Diameter	EA	1
15		Sawcut Bituminous Pavement (Full Depth)	LF	45
16		Remove and Dispose Bituminous Pavement	SY	705
17		Remove and Dispose of Concrete Pavement (P)	SY	31
18		Salvage and Place Topsoil (P)	CY	1,408
19		Excavation (P)	CY	23,291
20		Trail Subgrade Excavation	CY	972
21		Contaminated Sediment Excavation	CY	1,499
22		Offsite Disposal of Excavated Soil (Clean)	CY	21,440
23		Offsite Disposal of Excavated Sediment (Contaminated)	TON	2,398
24		Common Borrow Import	CY	647
25		Aggregate Base (CV), Class 5	CY	286
26		Bituminous Pavement (Typ)	SY	1,392
27		Concrete Pad for Bench, 6" reinforced (P)	SY	58
28		Victor Stanley, Inc. Model 8 Bench (Recycled Plastic, 6')	EA	4
29		60" CPEP Pipe Sewer #1 with Mitered Ends (Complete)	EA	1
30		60" CPEP Pipe Sewer #2 with Mitered Ends (Complete)	EA	1
31		60" CPEP Pipe Sewer #3 with Mitered Ends (Complete)	EA	1
32		Random Riprap, Class II with Filter Fabric (P)	TON	75
33		Granite Riprap, Class II (P)	TON	188
34		Granular Filter Material (P)	TON	78
35		Articulated Concrete Block	SF	1,500
36		Light Poles and Solar Fixtures (Complete)	EA	15
37		Erosion Control Blanket, Category 3N2S (Natural Net, includes maintenance)	SY	10,170
38		Seed, Oats Cover Crop	AC	2

90% DESIGN
NOT FOR CONSTRUCTION

CADD USER: Greg Nelson FILE: I:\DESIGN\23271901_00\23271901_G02_STATEMENT OF QUANTITIES.DWG PLOT SCALE: 1:2 PLOT DATE: 4/22/2022 4:04 PM

		I HEREBY CERTIFY THAT THIS PLAN, SPECIFICATION, OR REPORT WAS PREPARED BY ME OR UNDER MY DIRECT SUPERVISION AND THAT I AM A DULY LICENSED PROFESSIONAL ENGINEER UNDER THE LAWS OF THE STATE OF MINNESOTA.		CLIENT BID		12/10/21	04/22/22				Scale AS SHOWN		BARR PROJECT No. 23/27-1901.00		
		PRINTED NAME		CONSTRUCTION					Date 04/22/2022		Drawn ADB2		CLIENT PROJECT No. 20-26		
		SIGNATURE		RELEASED TO/FOR		A	B	C	0	1	2	3	DWG. No. G-02		
		DATE		DATE RELEASED					Checked KJN2		REV. No. B				
NO.		BY	CHK.	APP.	DATE	REVISION DESCRIPTION						Designed BARR		Approved KAL	



CITY OF GOLDEN VALLEY
GOLDEN VALLEY, MN

MEDLEY PARK
STORMWATER IMPROVEMENT
STATEMENT OF
ESTIMATED QUANTITIES

CADD USER: Greg Nelson FILE: M:\DESIGN\23271901_0032371901_001_EXISTINGCON_PEDTRAFFICCONTROL.DWG PLOT SCALE: 1:2 PLOT DATE: 4/22/2022 4:04 PM

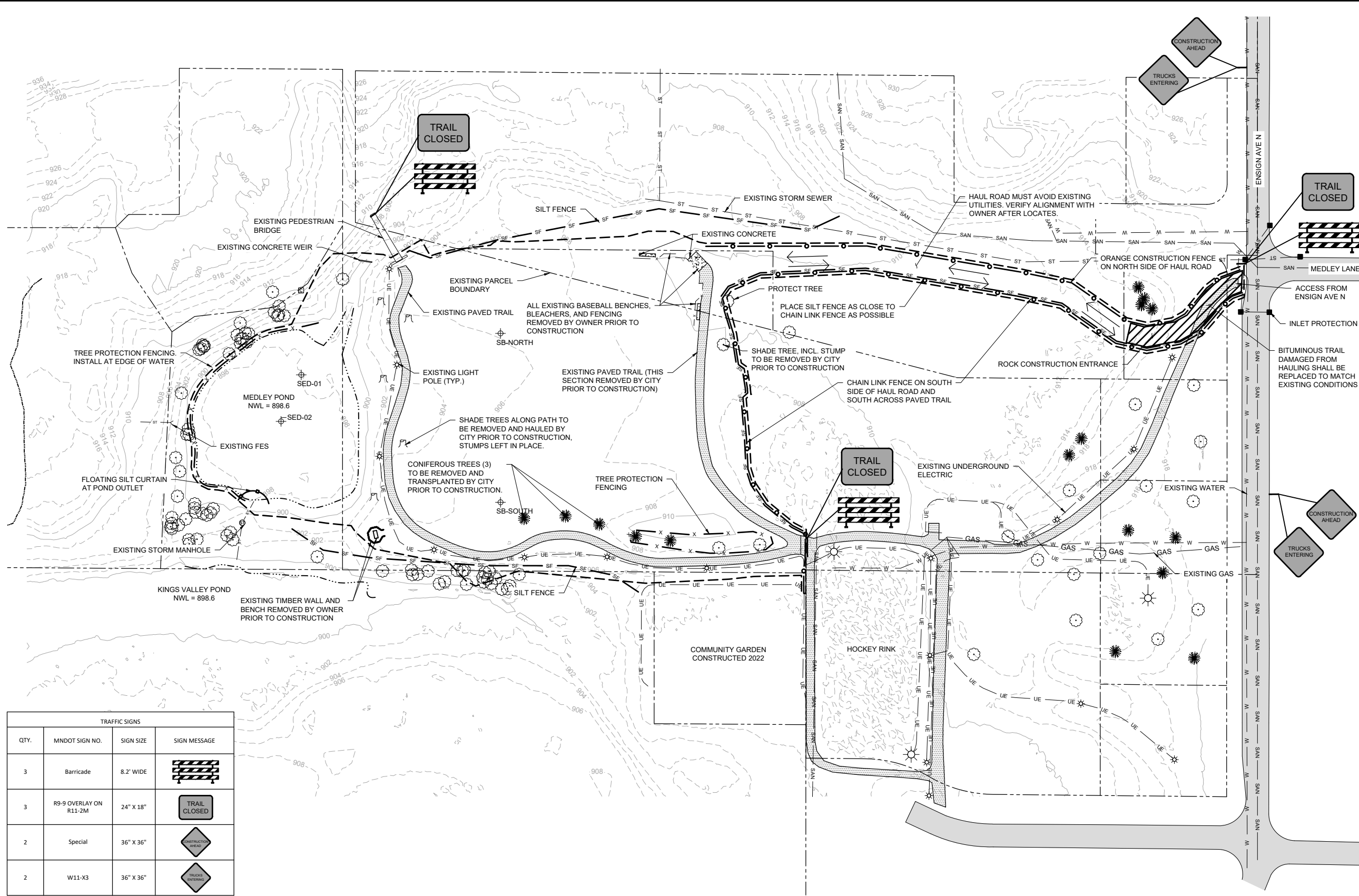

- EXISTING CONDITIONS LEGEND**
- 910 10-FT CONTOUR
 - 908 5-FT CONTOUR
 - PROPERTY LINE
 - ST ST NORMAL WATER LEVEL
 - SAN SAN STORM SEWER
 - SAN SAN SANITARY SEWER
 - W W WATER
 - GAS GAS GAS
 - UE UE UNDERGROUND ELECTRIC
 - X X FENCELINE
 - ⊕ STORM SEWER MANHOLE
 - ⊙ LIGHT POLE
 - ⊙ DECIDUOUS TREE
 - ⊙ CONIFEROUS TREE
 - ⊙ TREE STUMP
 - ⊙ SOIL BORING
 - CONCRETE
 - BITUMINOUS TRAIL
- PEDESTRIAN/TRAFFIC CONTROL LEGEND**
- CONSTRUCTION LIMITS
 - CONSTRUCTION FENCING
 - HAUL ROAD
- EROSION CONTROL LEGEND**
- 5 FLOATING SILT CURTAIN SW-03
 - 3 SILT FENCE SW-03
 - 2 TREE PROTECTION FENCING SW-04
 - 4 INLET PROTECTION SW-05
 - 2 CONSTRUCTION ENTRANCE SW-03

- NOTES:**
- 1) CONFIRM LOCATION OF ALL UNDERGROUND UTILITIES PRIOR TO CONSTRUCTION. NOTIFY OWNER OF ANY DISCREPANCIES.
 - 2) UTILITY LOCATIONS ARE APPROXIMATE. ALL UTILITIES IN THE PROJECT AREA SHOULD BE MARKED AND POTHOLED PRIOR TO EXCAVATION.
 - 3) ALL CONSTRUCTION ACCESS, PHASING, AND STAGING TO BE COORDINATED WITH CITY.
 - 4) ALL TRAFFIC/PEDESTRIAN CONTROL DEVICES AND SIGNAGE SHALL CONFORM TO THE MN MUTCD, INCLUDING FIELD MANUAL FOR TEMPORARY TRAFFIC CONTROL LAYOUTS. ALL TRAFFIC CONTROL SIGNS AND BARRICADES SHALL BE PLACED BY CONTRACTOR AND APPROVED BY THE CITY.
 - 5) UTILITY RELOCATION TO BE COORDINATED BY CONTRACTOR PRIOR TO CONSTRUCTION.
 - 6) PROTECT ALL EXISTING UTILITIES DURING DEMOLITION AND CONSTRUCTION.
 - 7) EROSION AND SEDIMENT CONTROL MEASURES SHALL BE INSTALLED BEFORE COMMENCING LAND DISTURBING ACTIVITIES AND SHALL NOT BE REMOVED UNTIL PERMANENT COVER HAS BEEN ESTABLISHED. SEE SWPPP.
 - 8) CONTRACTOR SHALL BE RESPONSIBLE FOR PROPER OPERATION, MAINTENANCE, AND REGULAR INSPECTION OF ALL EROSION AND SEDIMENT CONTROL MEASURES UNTIL THE SITE IS FULLY RESTORED.
 - 9) SOIL STOCKPILES SHALL BE STABILIZED WITH MULCH (SUCH AS STRAW MULCH, SLASH MULCH, WOOD CHIP, OR OTHER APPROPRIATE MULCH). IF SLOPES GREATER THAN 3H:1V, COVER MATERIAL WITH TARPS, PLASTIC SHEETING, OR EQUIVALENT MEASURES.
 - 10) IF SEDIMENT IS TRACKED ONTO CITY STREETS, STREET SWEEPING SHALL BE DEPLOYED. SEDIMENT SHALL BE REMOVED BY SWEEPING WITHIN 24 HOURS.
 - 11) FOR SWPPP, SEE SW-01 AND SW-02.
 - 12) FOR EROSION CONTROL NOTES AND DETAILS, SEE SW-03 AND SW-04.
 - 13) FOR SOIL BORING LOGS, SEE B-01.

TRAFFIC SIGNS			
QTY.	MNDOT SIGN NO.	SIGN SIZE	SIGN MESSAGE
3	Barricade	8.2" WIDE	
3	R9-9 OVERLAY ON R11-2M	24" X 18"	
2	Special	36" X 36"	
2	W11-X3	36" X 36"	

1 PLAN: EXISTING CONDITIONS, PED/TRAFFIC CONTROL & EROSION CONTROL

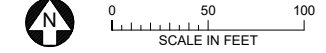

COORDINATE SYSTEM: HENNEPIN COUNTY
 HORIZONTAL DATUM: NAD83 (2011)
 VERTICAL DATUM: NAVD88

90% DESIGN
 NOT FOR CONSTRUCTION

	I HEREBY CERTIFY THAT THIS PLAN, SPECIFICATION, OR REPORT WAS PREPARED BY ME OR UNDER MY DIRECT SUPERVISION AND THAT I AM A DULY LICENSED PROFESSIONAL ENGINEER UNDER THE LAWS OF THE STATE OF MINNESOTA. PRINTED NAME: _____ SIGNATURE: _____ DATE: _____ LICENSE # _____	CLIENT: 12/10/21 04/22/22 CONSTRUCTION: _____ RELEASED TO/FOR: A B C 0 1 2 3 DATE RELEASED: _____	 Corporate Headquarters: Minneapolis, Minnesota Ph: 1-800-632-2277	Scale: AS SHOWN Date: 04/22/2022 Drawn: BARR Checked: KJN2 Designed: BARR Approved: KAL	CITY OF GOLDEN VALLEY GOLDEN VALLEY, MN	MEDLEY PARK STORMWATER IMPROVEMENT EXISTING CONDITIONS PED/TRAFFIC CONTROL & EROSION CONTROL	BARR PROJECT No. 23/27-1901.00 CLIENT PROJECT No. 20-26 DWG. No. C-01 REV. No. B
--	---	--	---	--	---	--	---

CADD USER: Greg Nelson FILE: M:\DESIGN\23271901_00\23271901_00_C02_REMOVALS.DWG PLOT SCALE: 1/2" = 1' PLOT DATE: 4/22/2022 4:05 PM

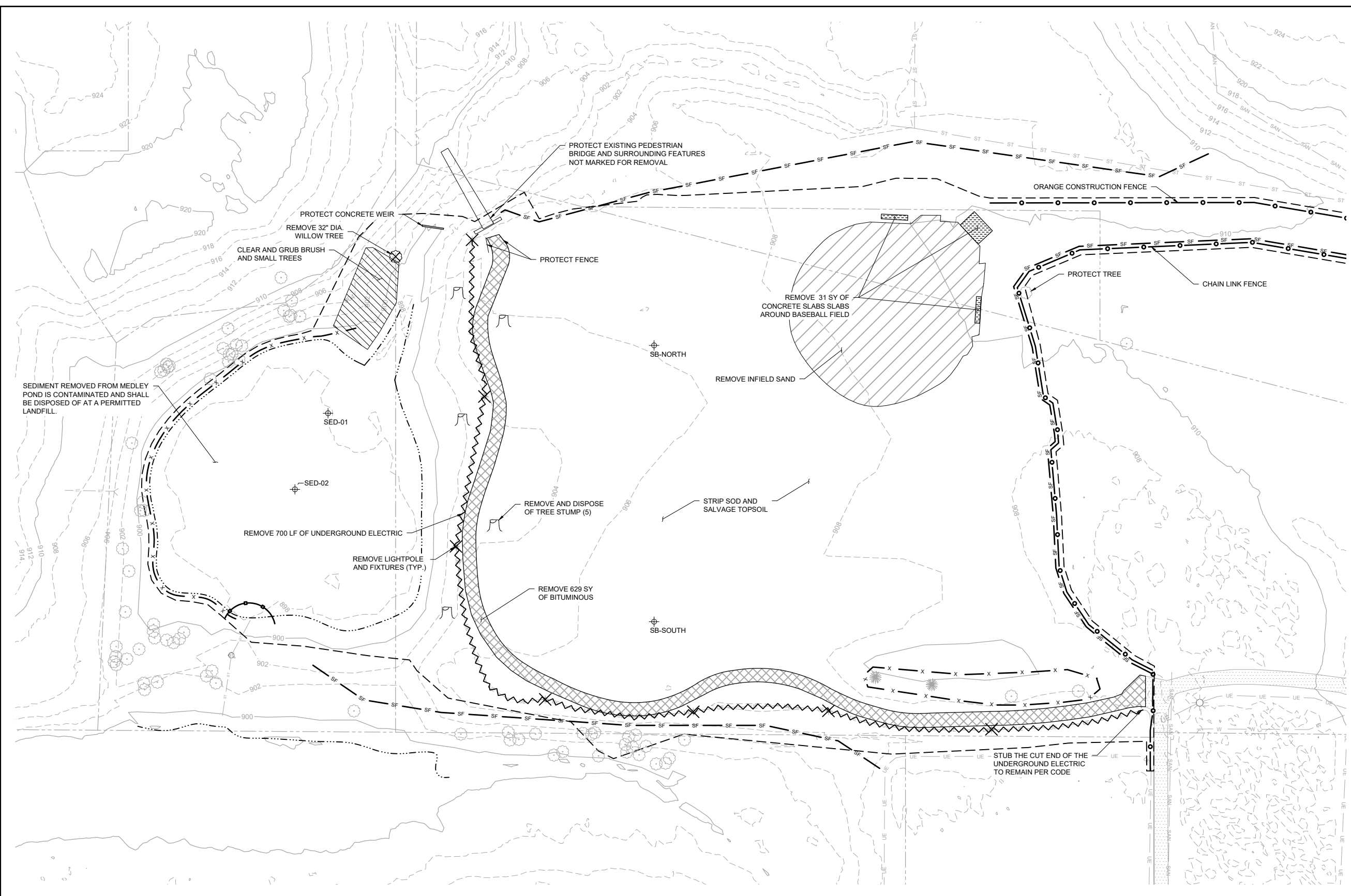

EXISTING CONDITIONS LEGEND

— 910 —	10-FT CONTOUR
- - - 908 - - -	5-FT CONTOUR
---	PROPERTY LINE
----	NORMAL WATER LEVEL
- ST - ST -	STORM SEWER
- SAN - SAN -	SANITARY SEWER
- W - W -	WATER
- GAS - GAS -	GAS
- UE - UE -	UNDERGROUND ELECTRIC
- X - X -	FENCELINE
⊕	STORM SEWER MANHOLE
⊙	LIGHT POLE
⊙	DECIDUOUS TREE
⊙	CONIFEROUS TREE
⊕	SOIL BORING
[Pattern]	CONCRETE
[Pattern]	BITUMINOUS TRAIL

REMOVALS LEGEND

---	CONSTRUCTION LIMITS
~~~~~	UTILITY REMOVAL
X	LIGHT POLE REMOVAL
[Pattern]	INFIELD SAND REMOVAL
[Pattern]	CONCRETE REMOVAL
[Pattern]	BITUMINOUS REMOVAL
[Pattern]	CLEARING AND GRUBBING
⊕	TREE STUMP REMOVAL
⊗	TREE REMOVAL

**PEDESTRIAN/TRAFFIC CONTROL LEGEND**

○-○-○	CONSTRUCTION FENCING
←→	HAUL ROAD

**EROSION CONTROL LEGEND**

○-○-○	FLOATING SILT CURTAIN
- SF - SF -	SILT FENCE
- X - X -	TREE PROTECTION FENCING

- NOTES:**
- 1) CONFIRM LOCATION OF ALL UNDERGROUND UTILITIES PRIOR TO CONSTRUCTION. NOTIFY OWNER OF ANY DISCREPANCIES.
  - 2) UTILITY LOCATIONS ARE APPROXIMATE. ALL UTILITIES IN THE PROJECT AREA SHOULD BE MARKED AND POTHOLED PRIOR TO EXCAVATION.
  - 3) UTILITY RELOCATION TO BE COORDINATED BY CONTRACTOR PRIOR TO CONSTRUCTION.
  - 4) PROTECT ALL EXISTING UTILITIES DURING DEMOLITION AND CONSTRUCTION.
  - 5) BITUMINOUS AND CONCRETE PAVEMENT TO BE RECYCLED. ALL OTHER DEMOLITION DEBRIS SHALL BE DISPOSED AT APPROPRIATE, LICENSED LANDFILLS.
  - 6) LIGHT POLES AND FIXTURES WITHIN CONSTRUCTION LIMITS SHALL BE REMOVED AND NEW LIGHT POLES/FIXTURES INSTALLED. SEE C-03.



90% DESIGN  
NOT FOR CONSTRUCTION

I HEREBY CERTIFY THAT THIS PLAN, SPECIFICATION, OR REPORT WAS PREPARED BY ME OR UNDER MY DIRECT SUPERVISION AND THAT I AM A DULY LICENSED PROFESSIONAL ENGINEER UNDER THE LAWS OF THE STATE OF MINNESOTA.				CLIENT BID CONSTRUCTION		12/10/21 4/22/22				Scale AS SHOWN		BARR PROJECT No. 23/27-1901.00	
PRINTED NAME SIGNATURE DATE LICENSE #				RELEASED TO/FOR A B C 0 1 2 3		DATE RELEASED		City of Golden Valley GOLDEN VALLEY, MN		Date 04/22/2022		CLIENT PROJECT No. 20-26	
NO. BY CHK. APP. DATE REVISION DESCRIPTION				B GGN KJN2 KAL 04/22/2022 ISSUED FOR 90% DESIGN REVIEW		A ADB2 KJN2 KAL 12/10/2021 ISSUED FOR REVIEW		Approved KAL		CITY OF GOLDEN VALLEY GOLDEN VALLEY, MN		STORMWATER IMPROVEMENT REMOVALS	
										DWG. No. C-02		REV. No. B	

**NOTES:**

- 1) CONFIRM LOCATION OF ALL UNDERGROUND UTILITIES PRIOR TO CONSTRUCTION. NOTIFY OWNER OF ANY DISCREPANCIES.
- 2) UTILITY LOCATIONS ARE APPROXIMATE. ALL UTILITIES IN THE PROJECT AREA SHOULD BE MARKED AND POTHOLED PRIOR TO EXCAVATION.
- 3) PROTECT ALL EXISTING UTILITIES DURING DEMOLITION AND CONSTRUCTION.
- 4) FOR EROSION/SEDIMENT CONTROL PLAN, SWPPP, AND DETAILS, SEE C-01, SW-01 TO SW-04.
- 5) FOR BITUMINOUS TRAIL PAVING PLAN, SEE C-07.
- 6) FOR SOIL BORING LOGS, SEE B-01.
- 7) FOR ELECTRICAL DETAILS, SEE C-11.
- 8) CONTRACTOR SHALL SUBMIT DEWATERING PLAN.
- 9) REMOVE ALL ORGANIC SOILS AND MUCK TO CONSTRUCT EMERGENCY OVERFLOW BERM.

**EXISTING CONDITIONS LEGEND**

- 890 5 FT CONTOUR
- 889 1 FT CONTOUR
- PROPERTY LINE
- NORMAL WATER LEVEL
- STORM SEWER
- UNDERGROUND ELECTRIC
- FENCELINE
- WOOD TIMBERS
- STORM SEWER MANHOLE
- LIGHT POLE
- DECIDUOUS TREE - DIAMETER
- CONIFEROUS TREE - DIAMETER
- SOIL BORING

**CONSTRUCTION LEGEND**

- GRADING LIMITS
- 890 5 FT CONTOUR
- 889 1 FT CONTOUR
- X 907.00 SPOT ELEVATION
- BITUMINOUS TRAIL
- NORMAL WATER LEVEL
- STORM SEWER
- LIGHT POLE (C-11)

COORDINATE SYSTEM: HENNEPIN COUNTY  
 HORIZONTAL DATUM: NAD83 (2011)  
 VERTICAL DATUM: NAVD88

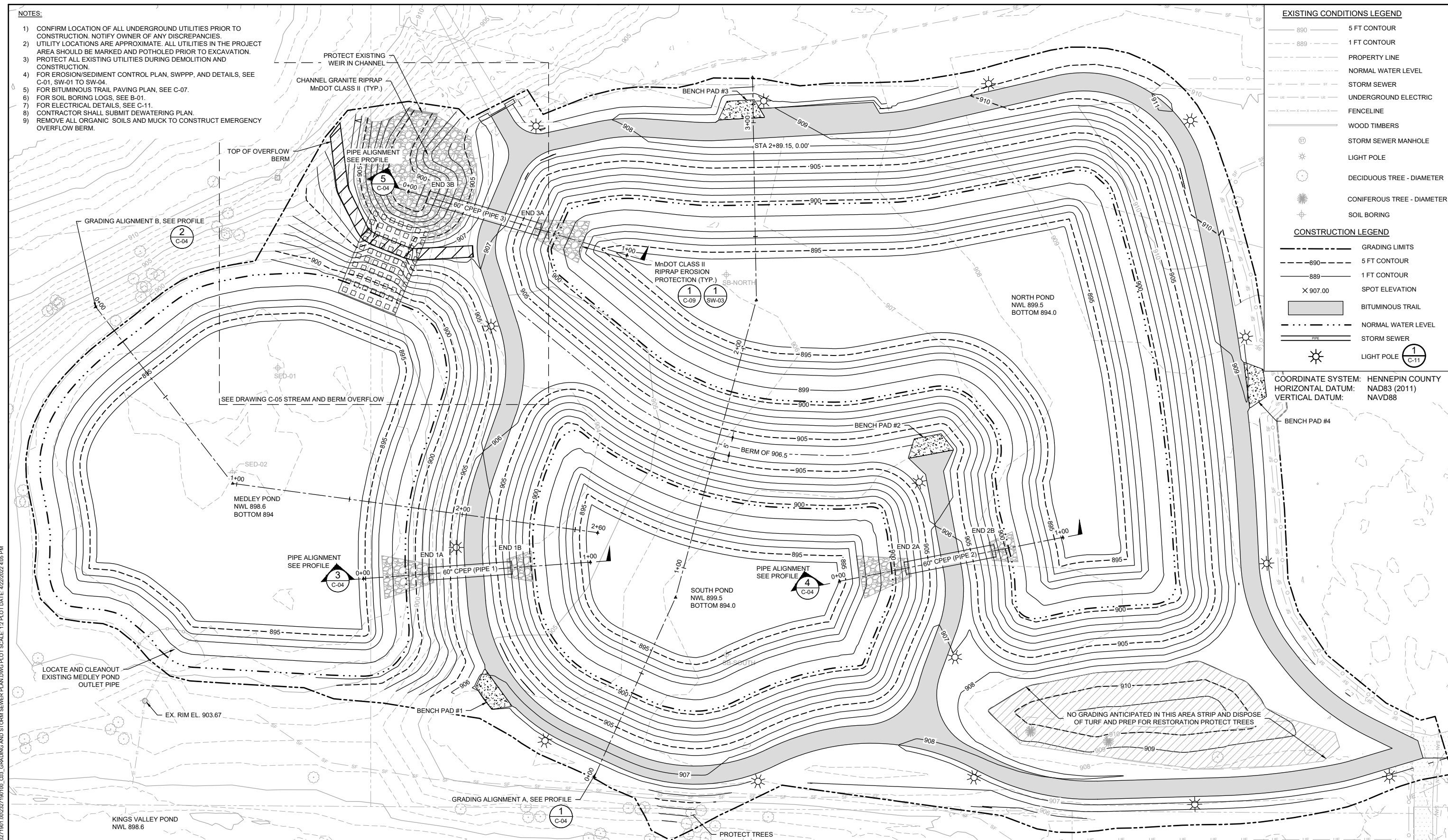

1 PLAN: GRADING AND STORM SEWER

90% DESIGN  
 NOT FOR CONSTRUCTION

CADD USER: Greg Nelson FILE: I:\DESIGN\23271901_003_Grading and Storm Sewer Plan.dwg PLOT SCALE: 1:2 PLOT DATE: 4/22/2022 4:08 PM

NO.	BY	CHK	APP	DATE	REVISION DESCRIPTION
B	GKN	KJN2	KAL	04/22/2022	ISSUED FOR 90% DESIGN REVIEW
A	GKN	KJN2	KAL	12/10/2021	ISSUED FOR REVIEW

I HEREBY CERTIFY THAT THIS PLAN, SPECIFICATION, OR REPORT WAS PREPARED BY ME OR UNDER MY DIRECT SUPERVISION AND THAT I AM A DULY LICENSED PROFESSIONAL ENGINEER UNDER THE LAWS OF THE STATE OF MINNESOTA.

PRINTED NAME: _____  
 SIGNATURE: _____  
 DATE: _____ LICENSE #: _____

CLIENT	BID	CONSTRUCTION	RELEASED TO/FOR	DATE RELEASED
2/10/21	4/22/22		A B C 0 1 2 3	

**BARR** golden valley

Corporate Headquarters:  
 Minneapolis, Minnesota  
 Ph: 1-800-632-2277

Scale	AS SHOWN
Date	04/22/2022
Drawn	BARR
Checked	KJN2
Designed	BARR
Approved	KAL

CITY OF GOLDEN VALLEY  
 GOLDEN VALLEY, MN

MEDLEY PARK  
 STORMWATER IMPROVEMENT  
 GRADING AND STORM SEWER  
 PLAN

BARR PROJECT No.	23/27-1901.00
CLIENT PROJECT No.	20-26
DWG. No.	C-03
REV. No.	B

CADD USER: Greg Nelson FILE: M:\DESIGN\23271901_00\23271901_00_PONDS AND STORM SEWER PROFILES.DWG PLOT SCALE: 1:12 PLOT DATE: 4/22/2022 4:05 PM

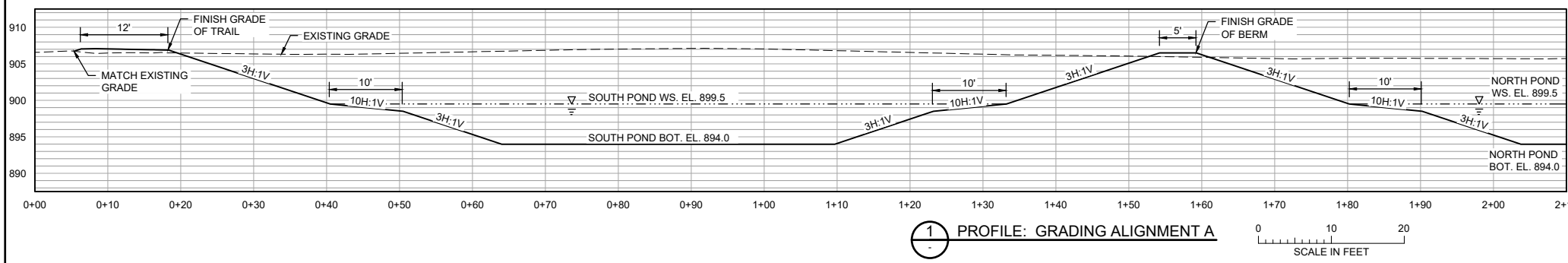

1 PROFILE: GRADING ALIGNMENT A

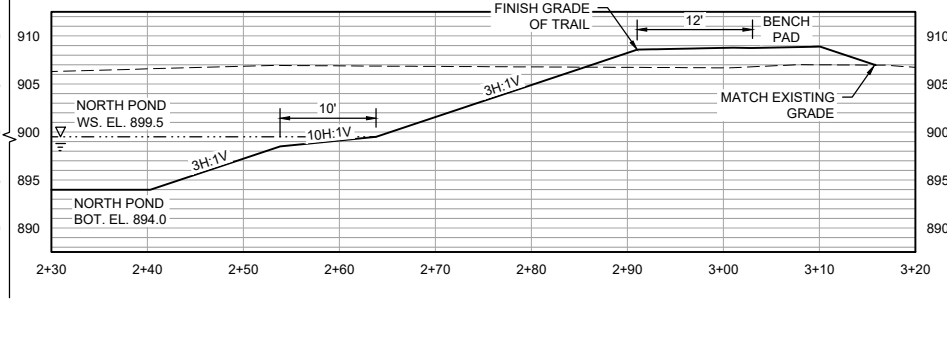
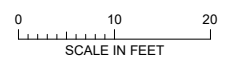

2 PROFILE: GRADING ALIGNMENT B

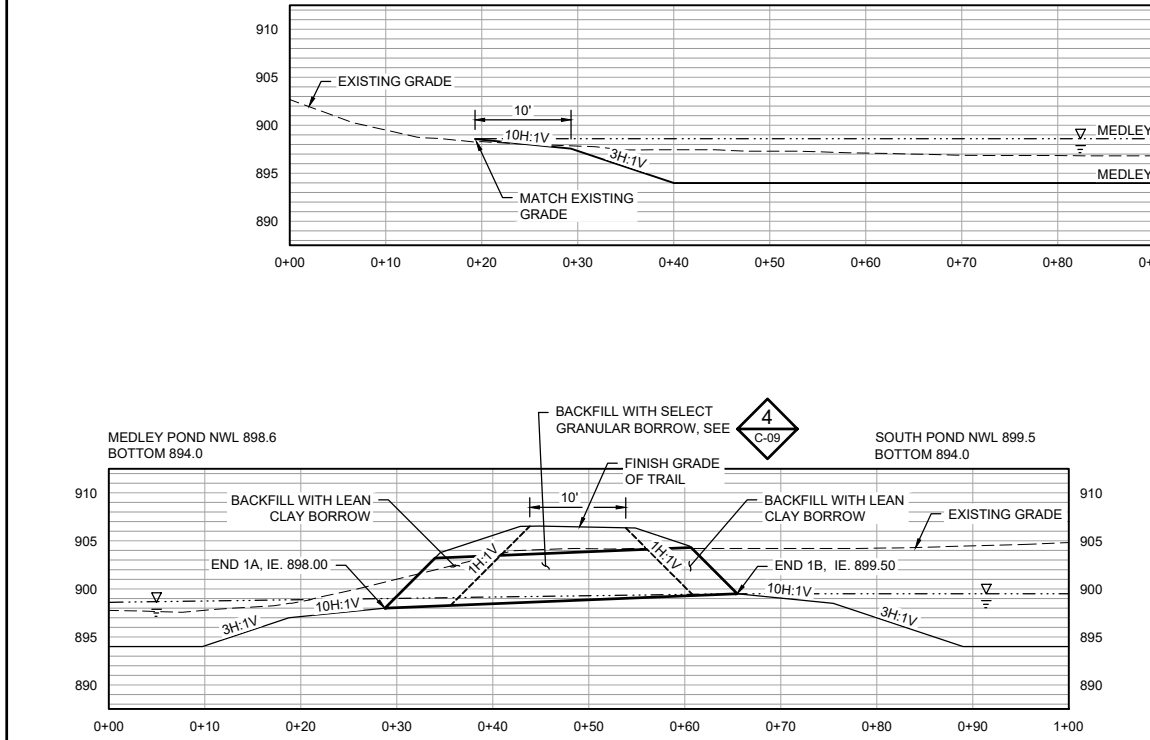
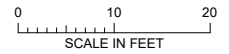

3 PROFILE: POND STORM PIPE 1

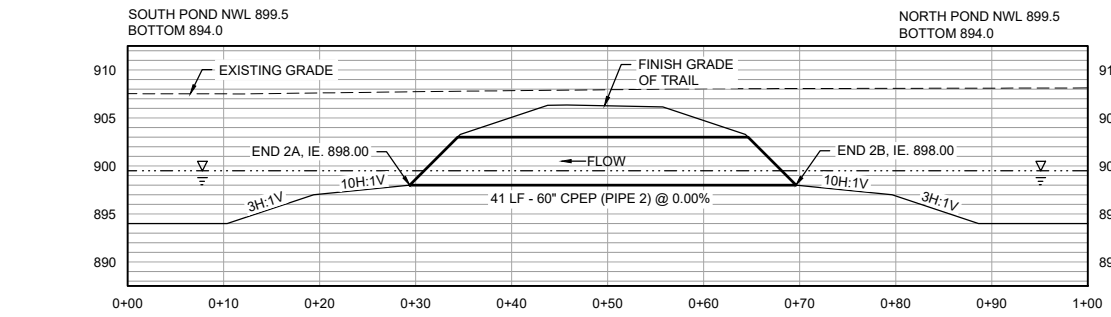
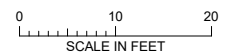

4 PROFILE: POND STORM PIPE 2

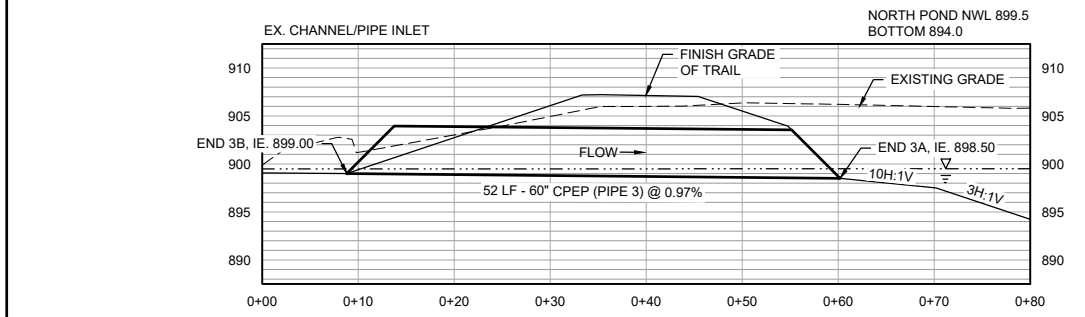
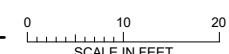

5 PROFILE: POND STORM PIPE 3

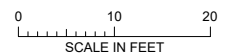

**STORM PIPE NOTES:**

1. STORM SEWER CULVERT PIPES SHOWN SHALL BE DUAL-WALL 60" DIA. CORRUGATED POLYETHYLENE PIPE (CPEP) WITH WATER TIGHT GASKETED JOINT CONNECTION.
2. PIPE INSTALLATION SHALL BE PERFORMED WITH PROPER TRENCH PREPARATION AND MATERIALS REQUIRED FOR PIPE BEDDING, PIPE HAUNCHING AND BACKFILL. COMPACTION AS SHOWN IN THE DRAWINGS AND SPECIFICATIONS.
3. TO MINIMIZE THE PIPE WALL EXPOSED AT THE SURFACE, FINAL GRADING AROUND PIPE MITERED END SECTION TO BE TRANSITIONED TO ADJACENT POND GRADES. RIPRAP AND FILTER MATERIALS SHALL BE INSTALLED AS SHOWN IN THE DRAWINGS.

90% DESIGN  
NOT FOR CONSTRUCTION

				I HEREBY CERTIFY THAT THIS PLAN, SPECIFICATION, OR REPORT WAS PREPARED BY ME OR UNDER MY DIRECT SUPERVISION AND THAT I AM A DULY LICENSED PROFESSIONAL ENGINEER UNDER THE LAWS OF THE STATE OF MINNESOTA.				CLIENT 2/10/21 4/22/22				Scale AS SHOWN			
				PRINTED NAME				CONSTRUCTION				Date 4/22/2022			
				SIGNATURE				RELEASED TO/FOR				Drawn GGN			
				DATE				DATE RELEASED				Checked KJN2			
				LICENSE #								Designed BARR			
												Approved KAL			



CITY OF GOLDEN VALLEY  
GOLDEN VALLEY, MN

MEDLEY PARK  
STORMWATER IMPROVEMENT  
PONDS AND STORM SEWER  
PROFILES

BARR PROJECT No. 23/27-1901.00	
CLIENT PROJECT No. 20-26	
DWG. No. C-04	REV. No. B



CADD USER: Greg Nelson FILE: I:\DESIGN\23271901_00\23271901_00_EOF_DETAILS.DWG PLOT SCALE: 1:2 PLOT DATE: 4/22/2022 4:05 PM

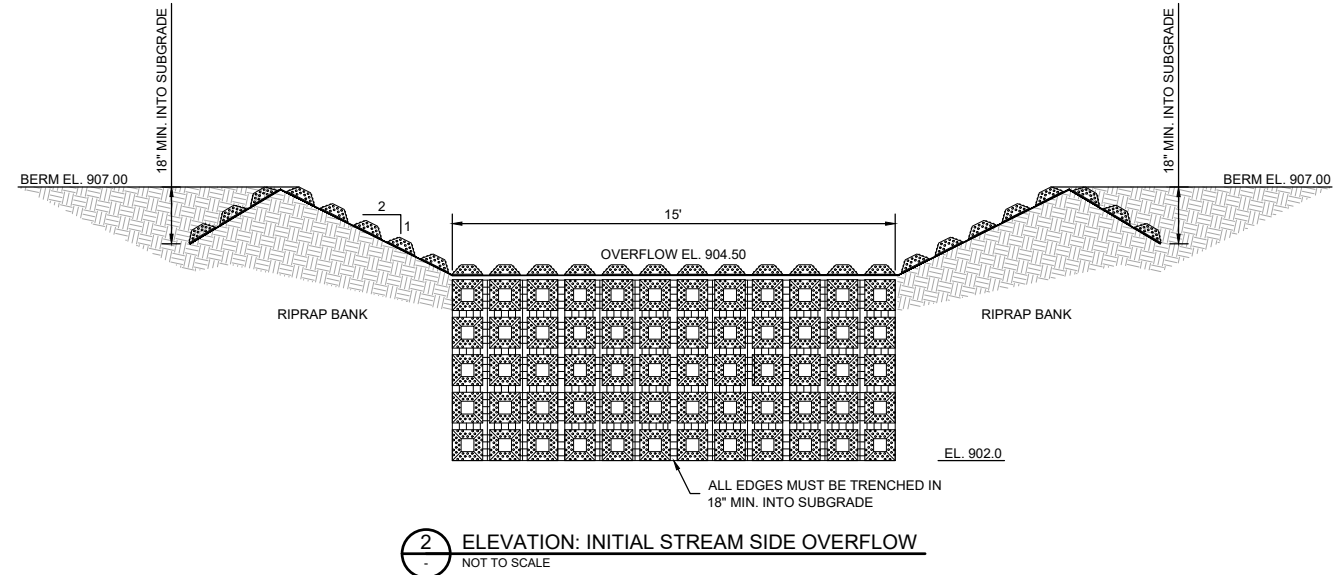
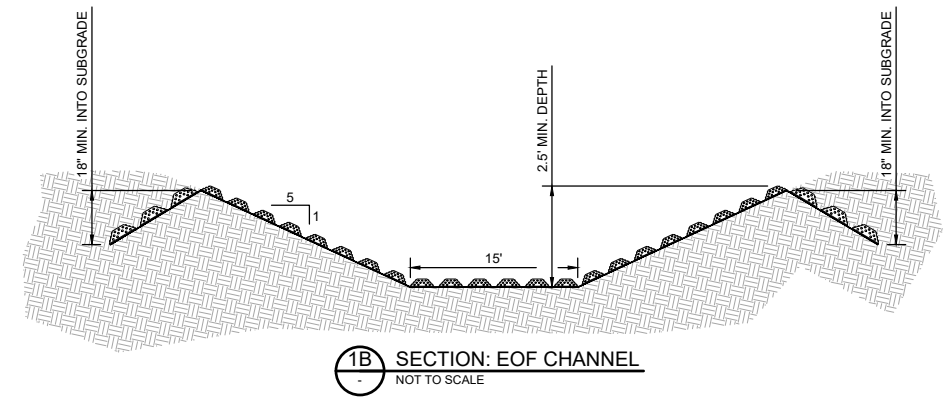
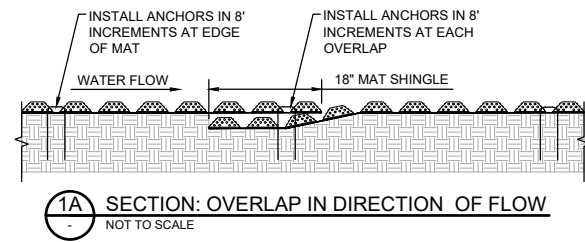
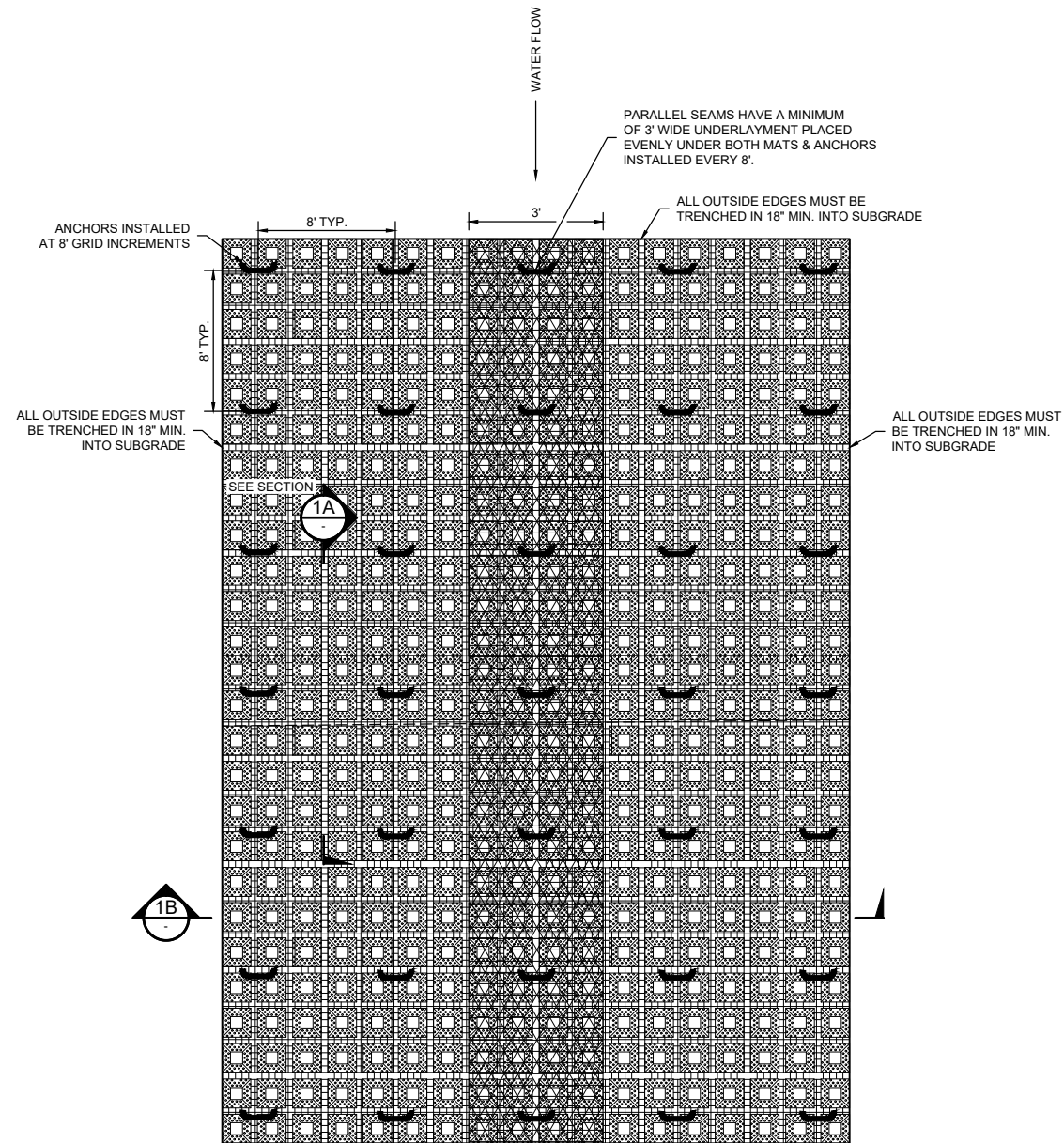

**NOTES:**

- CONTRACTOR WILL BE REQUIRED TO DETERMINE THE APPROPRIATE MAT SIZE UNIT SELECTED TO MINIMIZE PARALLEL SEAMS AND OVERLAPS.
- INSTALLATION SHALL BE IN ACCORDANCE WITH PRODUCT MANUFACTURER.
- FINAL LAYOUT CONFIGURATION OF MATS SHALL BE PROVIDED TO ENGINEER FOR REVIEW AND APPROVAL.



90% DESIGN  
NOT FOR CONSTRUCTION

					I HEREBY CERTIFY THAT THIS PLAN, SPECIFICATION, OR REPORT WAS PREPARED BY ME OR UNDER MY DIRECT SUPERVISION AND THAT I AM A DULY LICENSED PROFESSIONAL ENGINEER UNDER THE LAWS OF THE STATE OF MINNESOTA.					CLIENT BID		12/10/21	04/22/22				 Corporate Headquarters: Minneapolis, Minnesota Ph: 1-800-632-2277	Scale	AS SHOWN	CITY OF GOLDEN VALLEY GOLDEN VALLEY, MN	MEDLEY PARK STORMWATER IMPROVEMENT		BARR PROJECT No. 23/27-1901.00	
					PRINTED NAME _____					CONSTRUCTION					Date	04/22/2022		EMERGENCY OVERFLOW DETAILS			CLIENT PROJECT No. 20-26			
					SIGNATURE _____					RELEASED TO/FOR		A	B	C	0	1	2	3	Checked		GGN	DWG. No. C-06	REV. No. B	
					DATE _____ LICENSE # _____					DATE RELEASED					Designed	BARR								
NO.	BY	CHK.	APP.	DATE	REVISION DESCRIPTION										Approved	KAL								
B	GGN	KJN2	KAL	04/22/2022	ISSUED FOR 90% DESIGN REVIEW																			
A	ADB2	KJN2	KAL	12/10/2021	ISSUED FOR REVIEW																			



**CONSTRUCTION LEGEND**

- GRADING LIMITS
- - - 5 FT CONTOUR
- - - 1 FT CONTOUR
- X 907.00 SPOT ELEVATION
- BITUMINOUS TRAIL (1 C-10)
- STORM SEWER (1 C-11)
- LIGHT POLE (1 C-11)

COORDINATE SYSTEM: HENNEPIN COUNTY  
 HORIZONTAL DATUM: NAD83 (2011)  
 VERTICAL DATUM: NAVD88

2 C-10 OVERLOOK BENCH AND CONCRETE PAD, ANGLE OF PAD TO BE DETERMINED BY ENGINEER IN FIELD BEFORE PLACEMENT

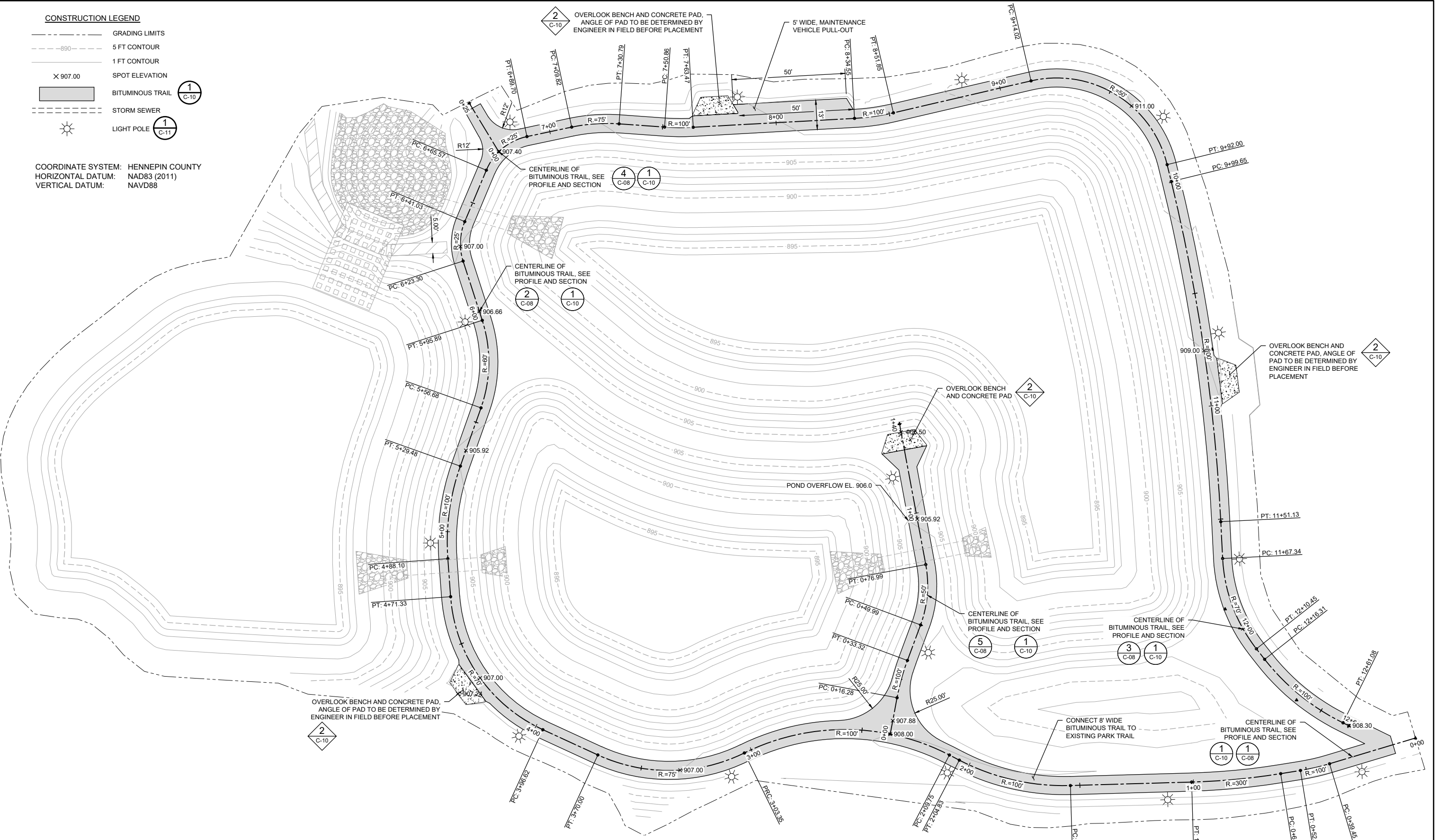

1 PLAN: GRADING AND STORM SEWER



90% DESIGN  
 NOT FOR CONSTRUCTION

CADD USER: Greg Nelson FILE: M:\DESIGN\23271901_00\23271901_00_C07-C08_TRAIL PAVING.DWG PLOT SCALE: 1:2 PLOT DATE: 4/22/2022 4:08 PM

NO.	BY	CHK	APP	DATE	REVISION DESCRIPTION
B	GKN	KJN2	KAL	04/22/2022	ISSUED FOR 90% DESIGN REVIEW
A	ADB2	KJN2	KAL	12/10/2021	ISSUED FOR REVIEW

I HEREBY CERTIFY THAT THIS PLAN, SPECIFICATION, OR REPORT WAS PREPARED BY ME OR UNDER MY DIRECT SUPERVISION AND THAT I AM A DULY LICENSED PROFESSIONAL ENGINEER UNDER THE LAWS OF THE STATE OF MINNESOTA.

PRINTED NAME: _____  
 SIGNATURE: _____  
 DATE: _____ LICENSE #: _____

CLIENT	12/10/21	04/22/22					
BID							
CONSTRUCTION							
RELEASED TO/FOR	A	B	C	0	1	2	3
DATE RELEASED							

**BARR** city of golden valley  
 Corporate Headquarters: Minneapolis, Minnesota  
 Ph: 1-800-632-2277

Scale	AS SHOWN
Date	04/22/2022
Drawn	BARR
Checked	KJN2
Designed	BARR
Approved	KAL

CITY OF GOLDEN VALLEY  
 GOLDEN VALLEY, MN

MEDLEY PARK  
 STORMWATER IMPROVEMENT  
 BITUMINOUS TRAIL  
 PAVING PLAN

BARR PROJECT No.	23/27-1901.00
CLIENT PROJECT No.	20-26
DWG. No.	C-07
REV. No.	B

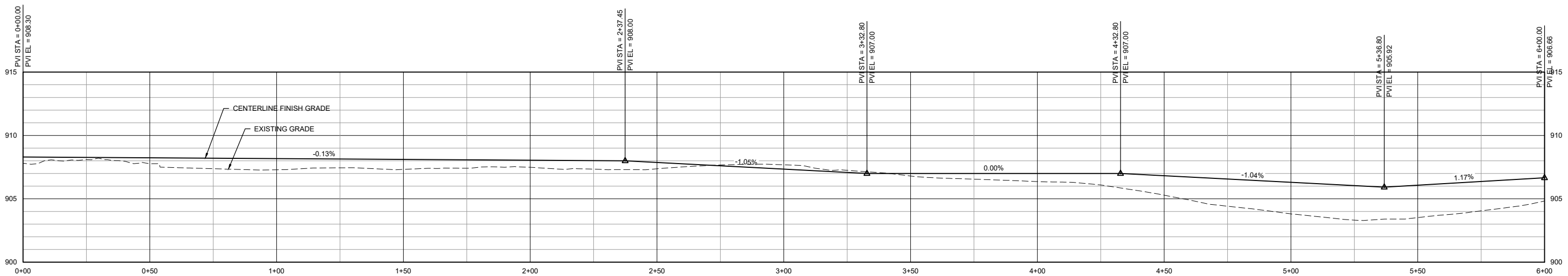

1 PROFILE: MAIN TRAIL (0+00 TO 6+00)

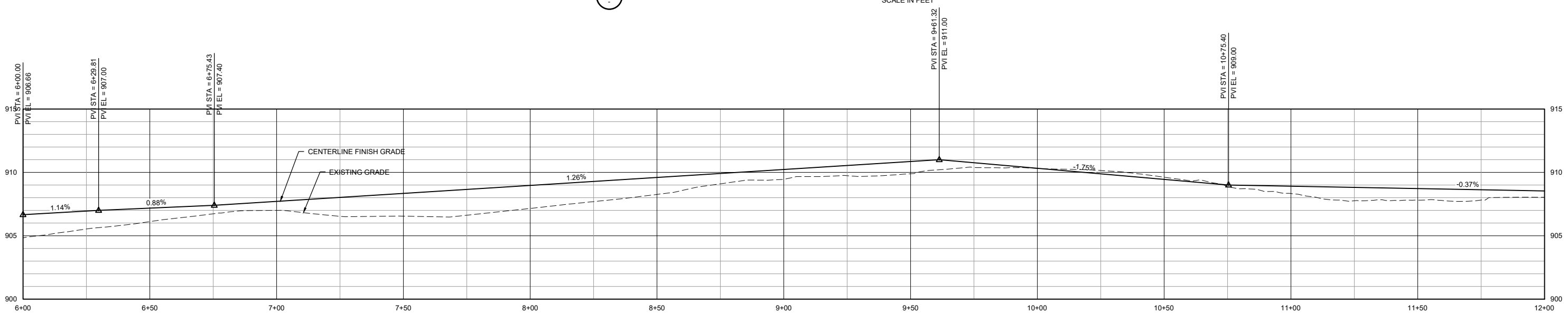
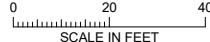

2 PROFILE: MAIN TRAIL (6+00 TO 12+00)

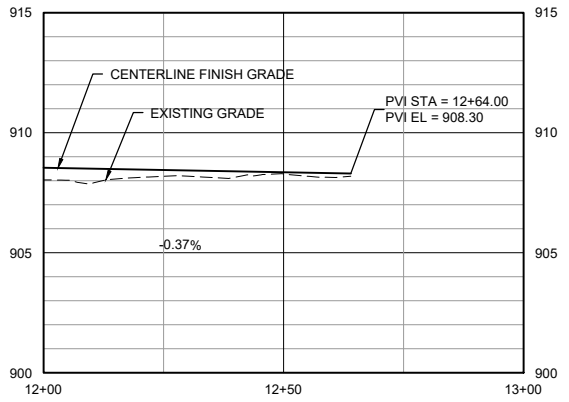
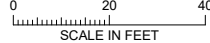

3 PROFILE: MAIN TRAIL (12+00 TO 13+00)

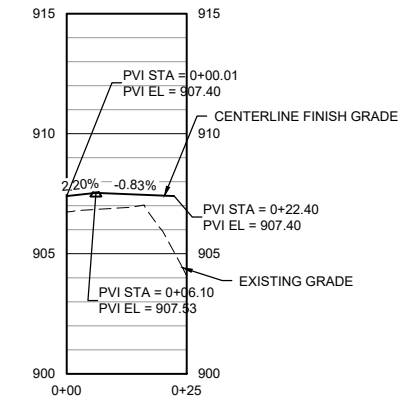
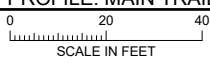

4 PROFILE: TRAIL BRANCH 1

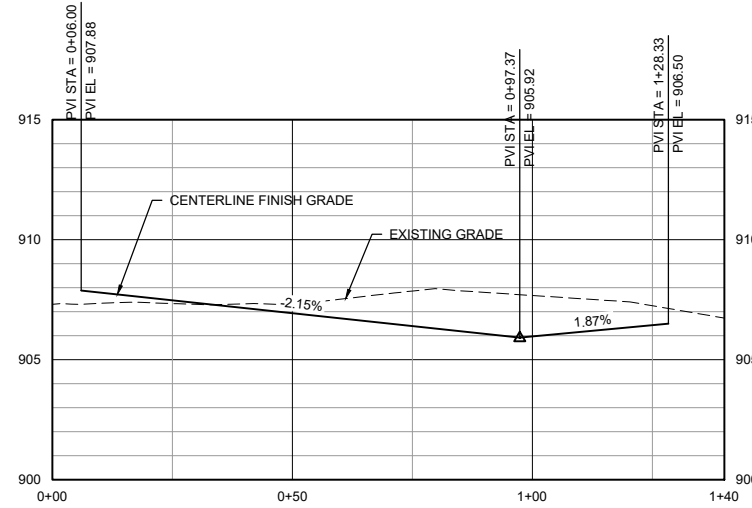
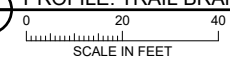

5 PROFILE: TRAIL BRANCH 2

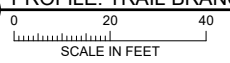

90% DESIGN  
NOT FOR CONSTRUCTION

CADD USER: Greg Nelson FILE: \\DESIGN\3271901_003271901_007+C08_TRAIL PAVING.DWG PLOT SCALE: 1:2 PLOT DATE: 4/22/2022 4:08 PM

NO.	BY	CHK	APP.	DATE	REVISION DESCRIPTION
B	GGN	KJN2	KAL	04/22/2022	ISSUED FOR 90% DESIGN REVIEW
A	ADB2	KJN2	KAL	12/10/2021	ISSUED FOR REVIEW

PRINTED NAME _____  
SIGNATURE _____  
DATE _____ LICENSE # _____

I HEREBY CERTIFY THAT THIS PLAN, SPECIFICATION, OR REPORT WAS PREPARED BY ME OR UNDER MY DIRECT SUPERVISION AND THAT I AM A DULY LICENSED PROFESSIONAL ENGINEER UNDER THE LAWS OF THE STATE OF MINNESOTA.

RELEASER TO/FOR	DATE RELEASED
A	0
B	1
C	2
0	3

CLIENT: 12/10/21 4/22/22  
 BID: _____  
 CONSTRUCTION: _____

Corporate Headquarters:  
 Minneapolis, Minnesota  
 Ph: 1-800-632-2277

Scale	AS SHOWN
Date	12/10/2021
Drawn	BARR
Checked	KJN2
Designed	BARR
Approved	KAL

CITY OF GOLDEN VALLEY  
 GOLDEN VALLEY, MN

MEDLEY PARK STORMWATER IMPROVEMENT		BARR PROJECT No. 23/27-1901.00	
BITUMINOUS TRAIL PAVING PROFILES		CLIENT PROJECT No. 20-26	
DWG. No. C-08	REV. No. B		

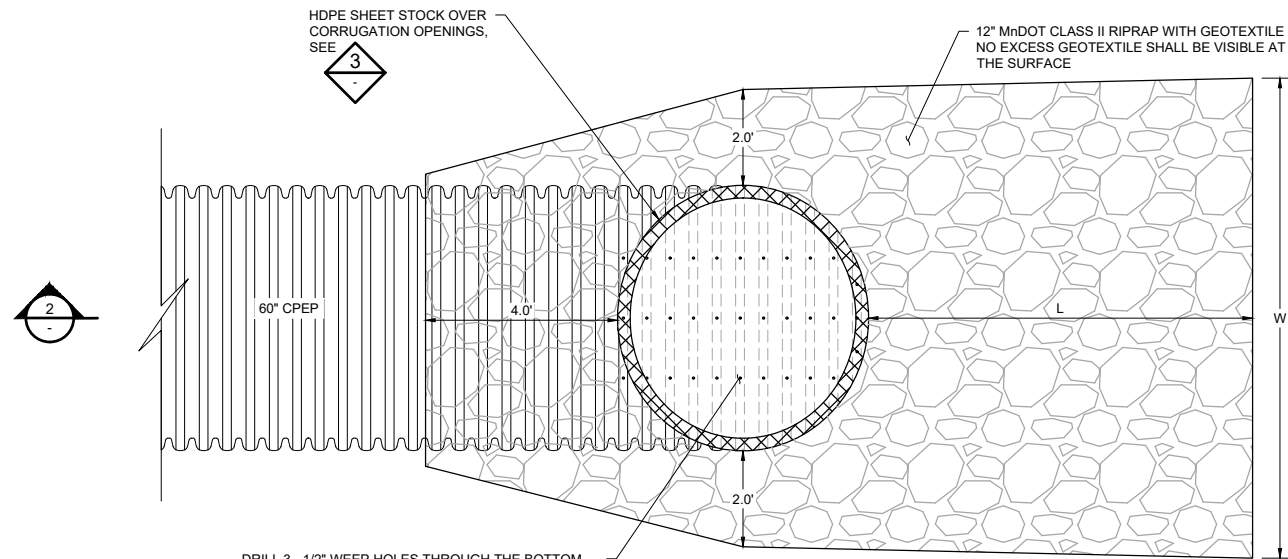

DRILL 3 - 1/2" WEEP HOLES THROUGH THE BOTTOM OF EACH CORRUGATION OPENED BY THE MITER CUT, SEE 5

PIPE END	L	W
END 1A	20	10
END 1B	10	10
END 2A	15	10
END 2B	10	10
END 3A	NA	NA
END 3B	20	10

EXTRUSION WELD HDPE SHEET STOCK (1/4" THICKNESS) TO FULLY COVER THE OPEN ENDS OF THE CORRUGATIONS. CONNECTION DOES NOT NEED TO BE WATER TIGHT. WELD SHALL SECURELY ATTACH SHEET STOCK TO PIPE BUT WELD DOES NOT NEED TO BE CONTINUOUS.

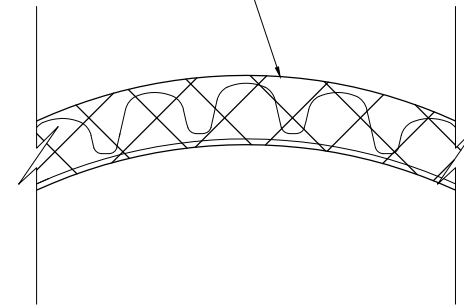

CPEP CORRUGATION OPENED BY MITER CUT

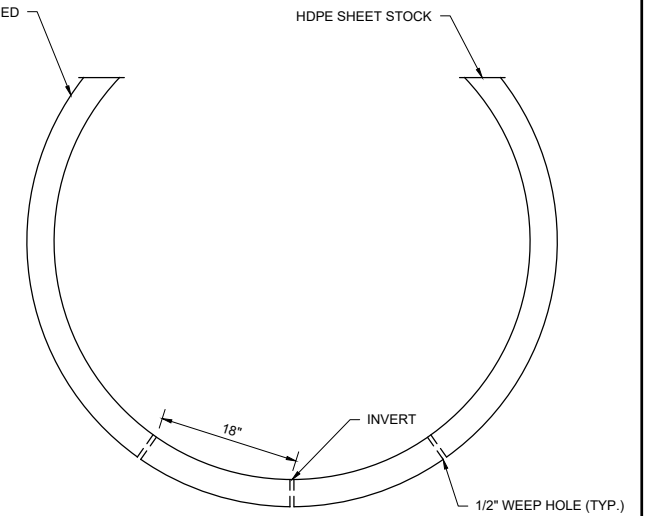

NOTES:

- SHEET STOCK DOES NOT NEED TO BE ONE PIECE. IT CAN BE AS MANY AS 4 PIECES EXTRUSION WELDED TOGETHER. SUBMIT SHOP DRAWING.

3 DETAIL: HDPE SHEET STOCK OVER OPENINGS IN CORRUGATIONS  
NOT TO SCALE

5 DETAIL: WEEP HOLES  
NOT TO SCALE

1 PLAN: CUSTOM MITERED CPEP END SECTION AND RIPRAP PLACEMENT

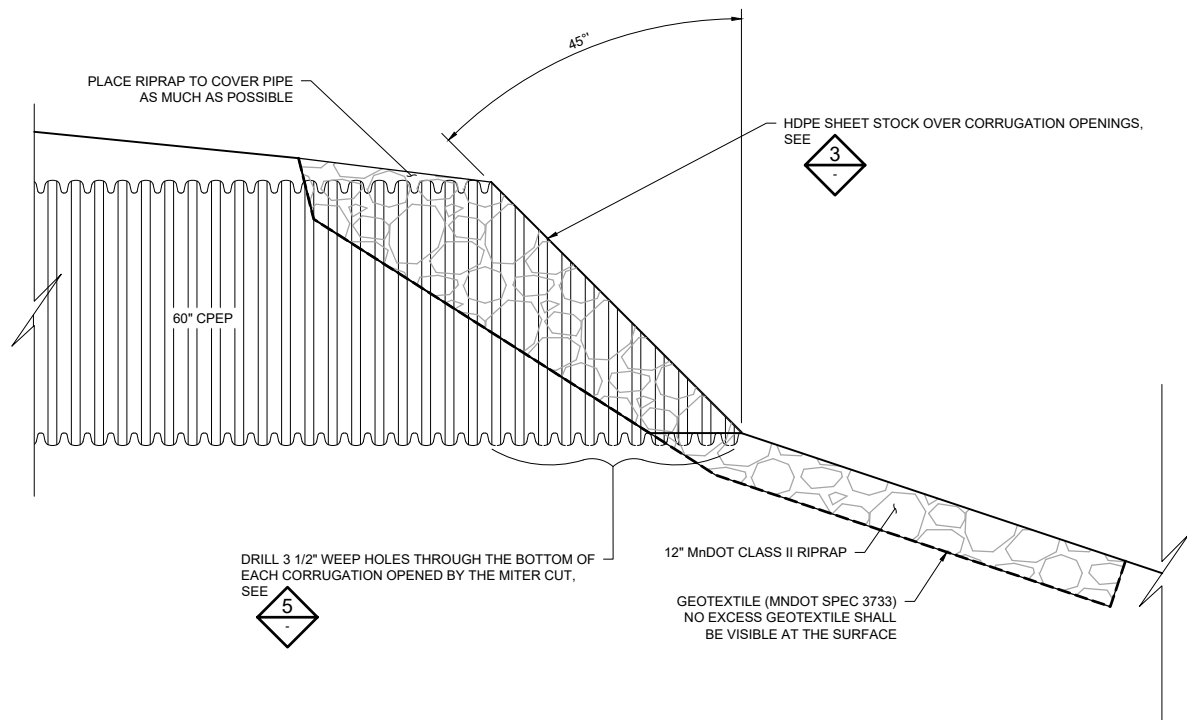
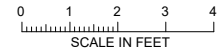

DRILL 3 1/2" WEEP HOLES THROUGH THE BOTTOM OF EACH CORRUGATION OPENED BY THE MITER CUT, SEE 5

GEOTEXTILE (MNDOT SPEC 3733) NO EXCESS GEOTEXTILE SHALL BE VISIBLE AT THE SURFACE

2 SECTION: CUSTOM MITERED CPEP END SECTION

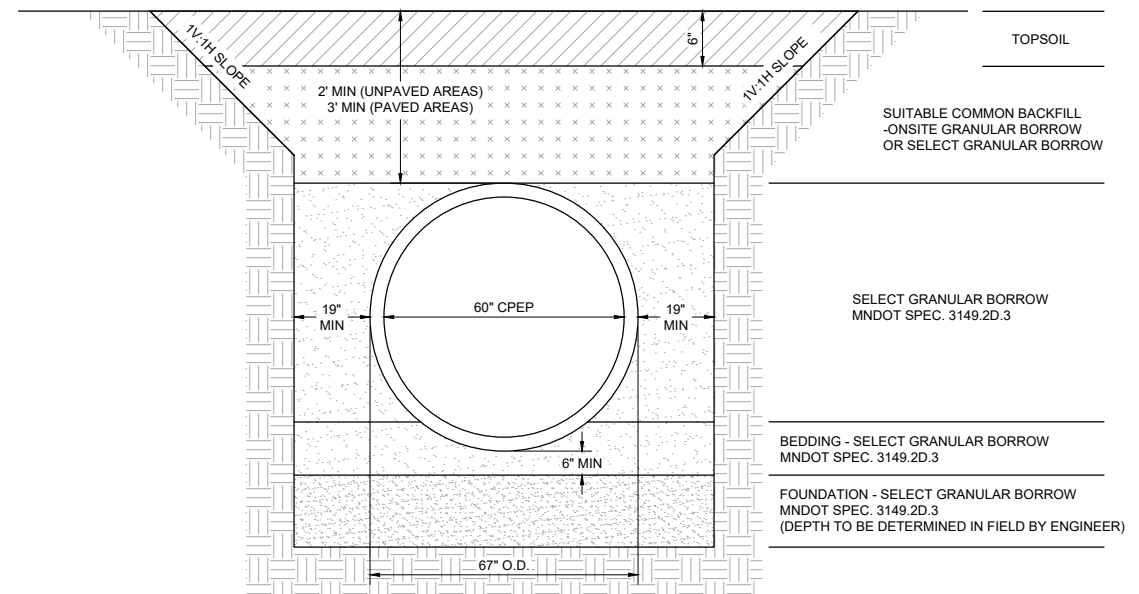
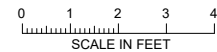

4 DETAIL: INSTALLATION OF 60" CORRUGATED HDPE PIPE  
NOT TO SCALE

90% DESIGN  
NOT FOR CONSTRUCTION

CADD USER: Greg Nelson FILE: I:\DESIGN\23271901_00\23271901_00_STORM DETAILS.DWG PLOT SCALE: 1:2 PLOT DATE: 4/22/2022 4:08 PM

NO.	BY	CHK	APP	DATE	REVISION DESCRIPTION
B	GGN	KJN2		3/16/2022	ISSUED FOR 90% DESIGN REVIEW
A	ADB2	KJN2	KAL	12/10/2021	ISSUED FOR REVIEW

I HEREBY CERTIFY THAT THIS PLAN, SPECIFICATION, OR REPORT WAS PREPARED BY ME OR UNDER MY DIRECT SUPERVISION AND THAT I AM A DULY LICENSED PROFESSIONAL ENGINEER UNDER THE LAWS OF THE STATE OF MINNESOTA.

PRINTED NAME: _____  
SIGNATURE: _____  
DATE: _____ LICENSE #: _____

CLIENT	12/10/21	4/22/22							
BID									
CONSTRUCTION									
RELEASED TO/FOR	A	B	C	0	1	2	3		
DATE RELEASED									

**BARR** golden valley  
Corporate Headquarters:  
Minneapolis, Minnesota  
Ph: 1-800-632-2277



Scale	AS SHOWN
Date	12/10/2021
Drawn	BARR
Checked	KJN2
Designed	BARR
Approved	KAL

CITY OF GOLDEN VALLEY  
GOLDEN VALLEY, MN

MEDLEY PARK  
STORMWATER IMPROVEMENT  
DETAILS  
STORM SEWER

BARR PROJECT No.	23/27-1901.00
CLIENT PROJECT No.	20-26
DWG. No.	C-09
REV. No.	B

CADD USER: Greg Nelson FILE: I:\DESIGN\23271901_00\3271901_00_C10_TRAIL DETAILS.DWG PLOT SCALE: 1:2 PLOT DATE: 4/22/2022 4:08 PM

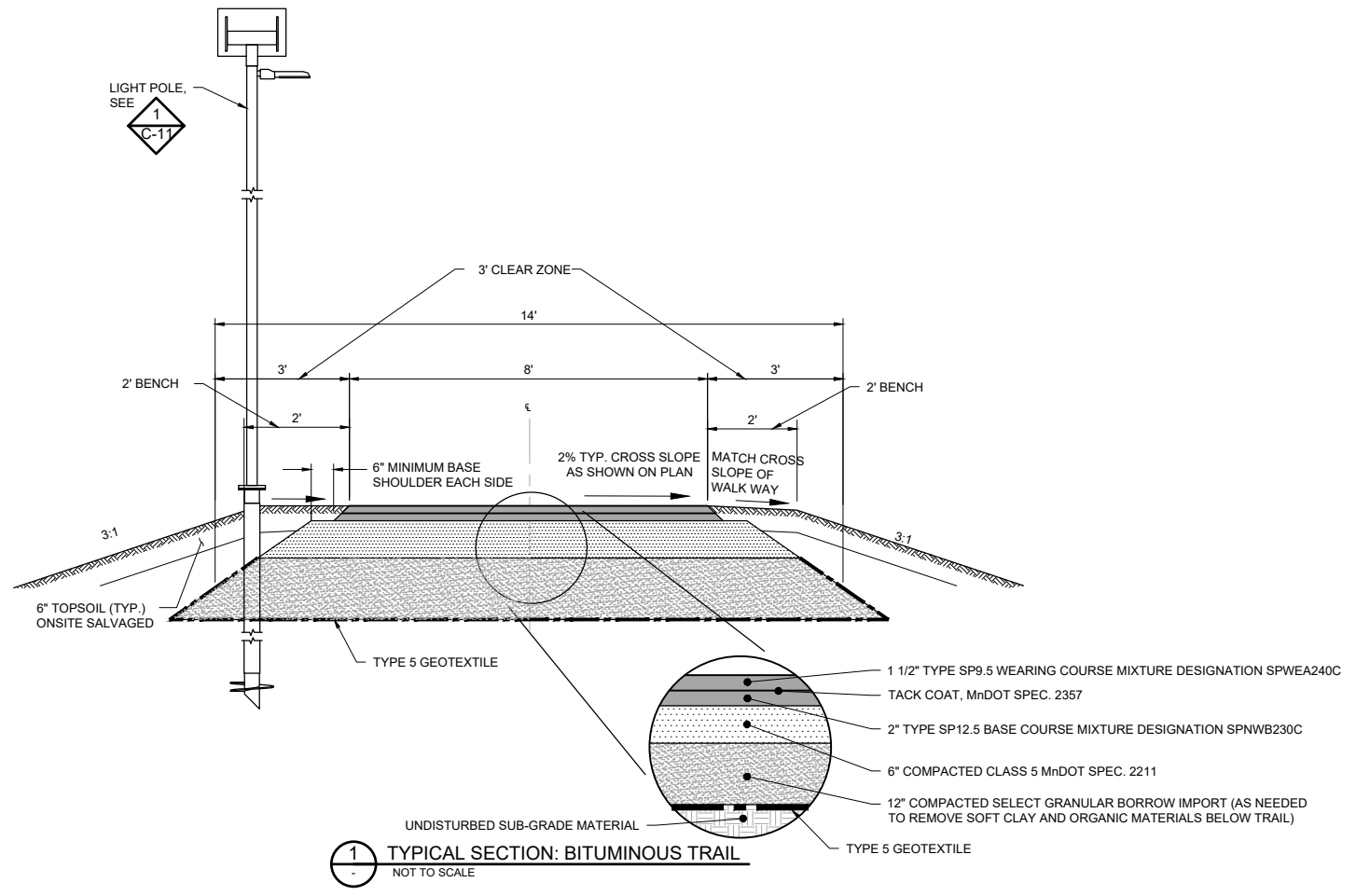

**1** TYPICAL SECTION: BITUMINOUS TRAIL  
NOT TO SCALE

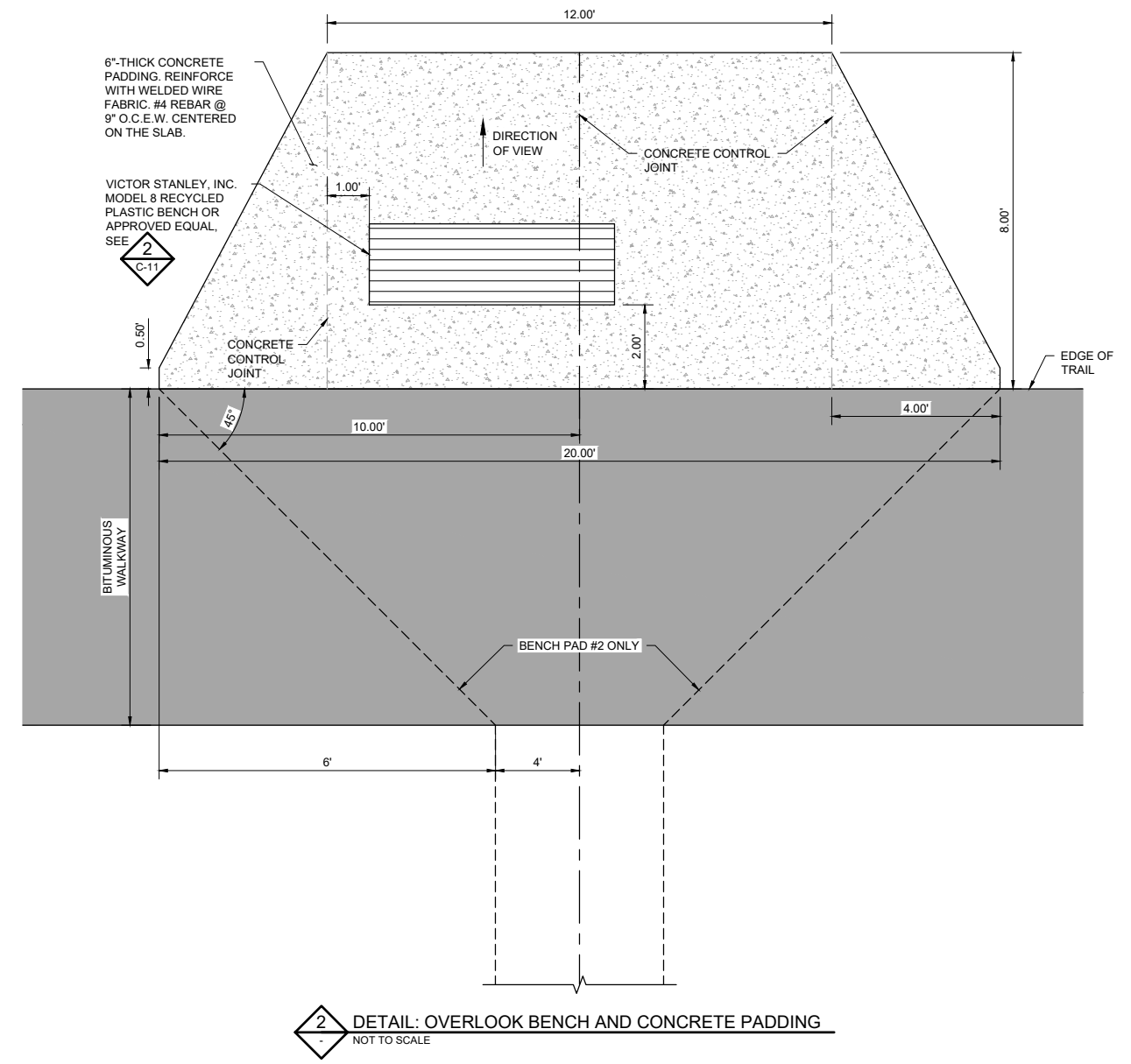

**2** DETAIL: OVERLOOK BENCH AND CONCRETE PADDING  
NOT TO SCALE

90% DESIGN  
NOT FOR CONSTRUCTION

				I HEREBY CERTIFY THAT THIS PLAN, SPECIFICATION, OR REPORT WAS PREPARED BY ME OR UNDER MY DIRECT SUPERVISION AND THAT I AM A DULY LICENSED PROFESSIONAL ENGINEER UNDER THE LAWS OF THE STATE OF MINNESOTA.				CLIENT BID CONSTRUCTION				1/2/2021 4/22/22						Scale AS SHOWN		<b>CITY OF GOLDEN VALLEY</b> GOLDEN VALLEY, MN		<b>MEDLEY PARK</b> STORMWATER IMPROVEMENT		BARR PROJECT No. 23/27-1901.00	
				PRINTED NAME _____				RELEASED TO/FOR				Date 04/22/2022		CLIENT PROJECT No. 20-26											
				SIGNATURE _____				A B C 0 1 2 3				Drawn BARR		DETAILS - BITUMINOUS TRAIL, CONCRETE PAD, AND BENCH		DWG. No. C-10		REV. No. B							
				DATE _____ LICENSE # _____				DATE RELEASED				Checked KJN2													
												Designed BARR													
												Approved KAL													

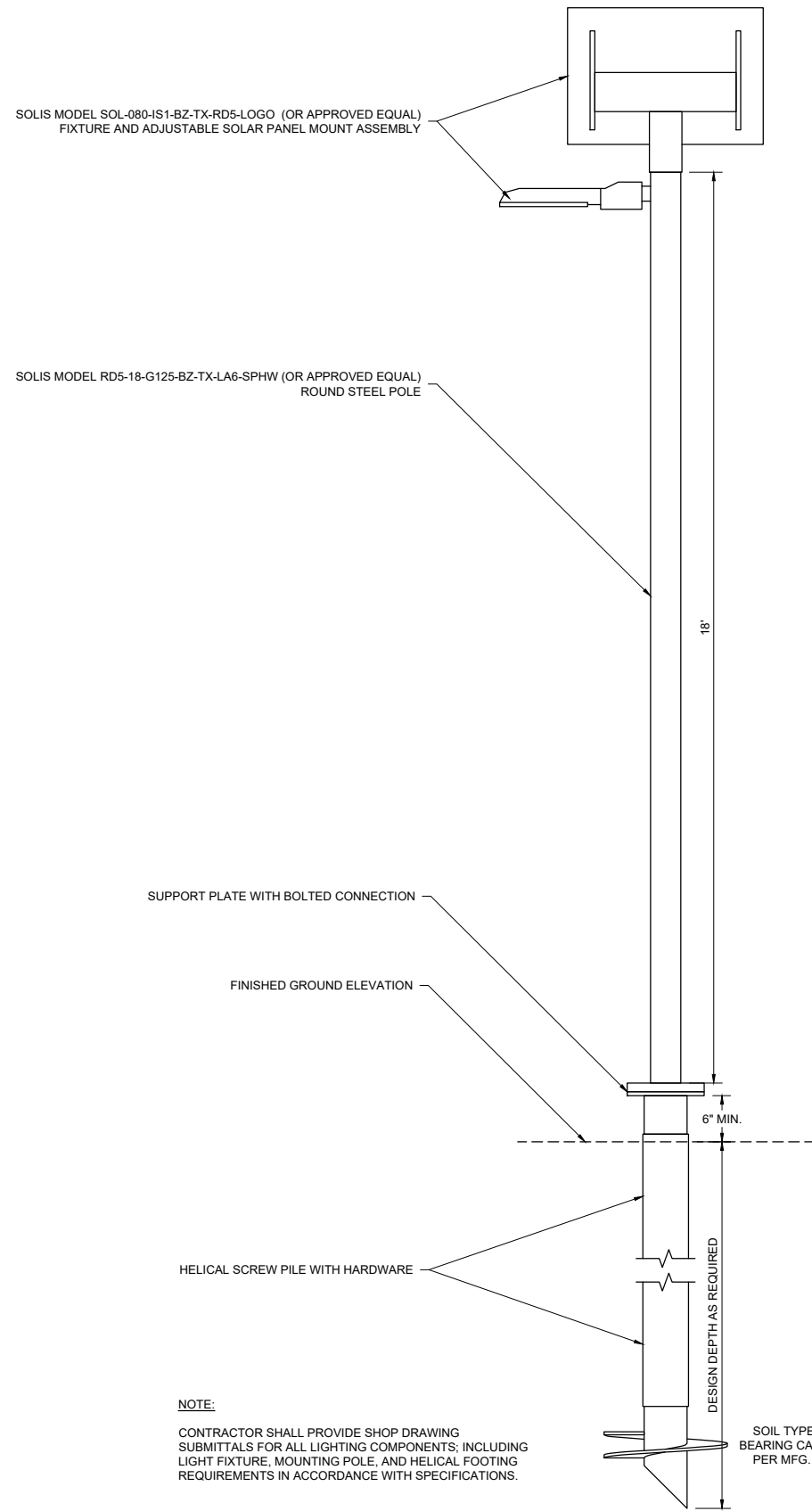

**NOTE:**  
 CONTRACTOR SHALL PROVIDE SHOP DRAWING SUBMITTALS FOR ALL LIGHTING COMPONENTS; INCLUDING LIGHT FIXTURE, MOUNTING POLE, AND HELICAL FOOTING REQUIREMENTS IN ACCORDANCE WITH SPECIFICATIONS.

**1** **DETAIL: INTEGRATED SOLAR LIGHTING SYSTEM**  
 NOT TO SCALE

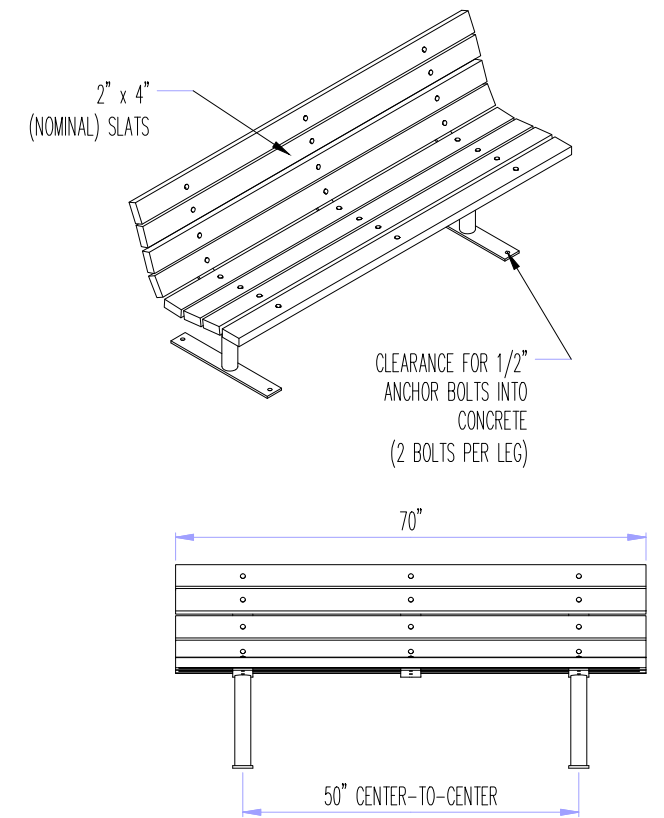
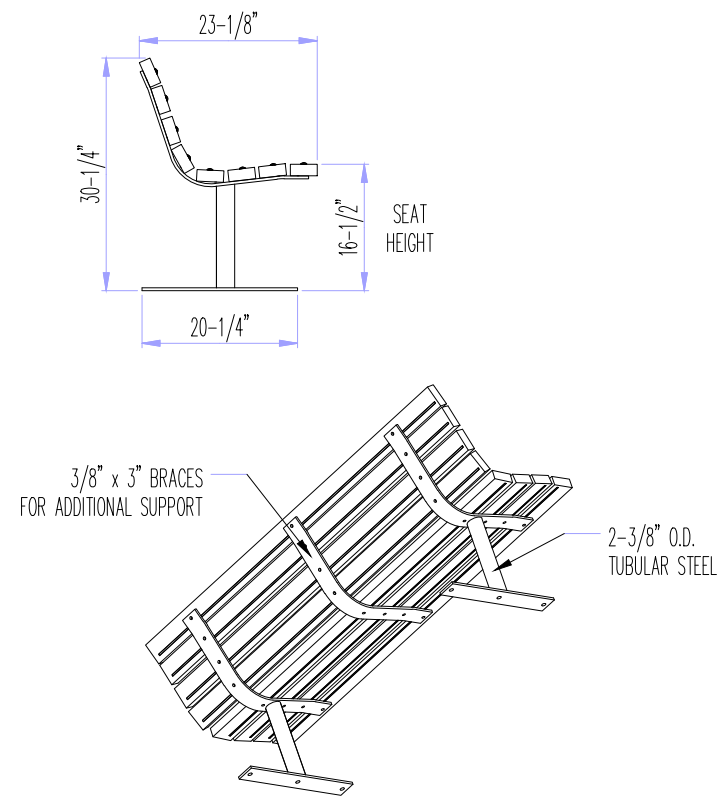

**2** **DETAIL: VICTOR STANLEY, INC. MODEL 8 BENCH**  
 NOT TO SCALE

**NOTES:**

1. BENCH TYPE
  - 1.1. VICTOR STANLEY, INC. MODEL 8 (HOMESTEAD COLLECTION) OR APPROVED EQUAL
    - 1.1.1. STANDARD 6-FOOT LENGTH
    - 1.1.2. STANDARD 2ND SITE SYSTEMS SLATS (RECYCLED PLASTIC)
    - 1.1.4. SLATS COLOR: MAPLE
    - 1.1.5. STANDARD SURFACE MOUNT
    - 1.1.6. NO ARM RESTS
2. WINTER SALTING CONSIDERATIONS
  - 2.1. METAL COMPONENTS OF THE BENCH SHOULD BE TREATED FOR HIGH SALT ABUSE. HOT-DIP GALVANIZING BEFORE POWDER COATING IS AVAILABLE AND PERFORMED FOR VICTOR STANLEY, INC. BY AN EXPERIENCED QUALIFIED FIRM. CONTRACTOR TO CONTACT MANUFACTURER FOR DETAILS.
3. INSTALL BENCH PER MANUFACTURER'S RECOMMENDATIONS.

90% DESIGN  
 NOT FOR CONSTRUCTION

CADD USER: Greg Nelson FILE: M:\DESIGN\23271901_00\23271901_00_C11_DETAILS.DWG PLOT SCALE: 1:2 PLOT DATE: 4/22/2022 4:08 PM

NO.	BY	CHK	APP	DATE	REVISION DESCRIPTION
B	GGN	KJN2	KAL	04/22/2022	ISSUED FOR 90% DESIGN REVIEW
A	ADB2	KJN2	KAL	12/10/2021	ISSUED FOR REVIEW

I HEREBY CERTIFY THAT THIS PLAN, SPECIFICATION, OR REPORT WAS PREPARED BY ME OR UNDER MY DIRECT SUPERVISION AND THAT I AM A DULY LICENSED PROFESSIONAL ENGINEER UNDER THE LAWS OF THE STATE OF MINNESOTA.

PRINTED NAME _____  
 SIGNATURE _____  
 DATE _____ LICENSE # _____

CLIENT	2/10/21	4/22/22							
BID									
CONSTRUCTION									
RELEASED TO/FOR	A	B	C	0	1	2	3		
DATE RELEASED									

**BARR**  
 Corporate Headquarters:  
 Minneapolis, Minnesota  
 Ph: 1-800-632-2277

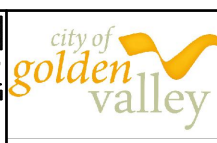

Scale	AS SHOWN
Date	04/22/2022
Drawn	BARR
Checked	KJN2
Designed	BARR
Approved	KAL

CITY OF GOLDEN VALLEY  
 GOLDEN VALLEY, MN

MEDLEY PARK  
 STORMWATER IMPROVEMENT  
 DETAILS  
 SITE FEATURES

BARR PROJECT No.	23/27-1901.00
CLIENT PROJECT No.	20-26
DWG. No.	C-11
REV. No.	B



SEE C-12 FOR ACCESS ROUTE TEMPORARY WINTER EROSION CONTROL

**EXISTING CONDITIONS LEGEND**

---	PROPERTY LINE
---	NORMAL WATER LEVEL
ST	STORM SEWER
SAN	SANITARY SEWER
W	WATER
GAS	GAS
UE	UNDERGROUND ELECTRIC
⊙	STORM SEWER MANHOLE
☀	LIGHT POLE
⊙	DECIDUOUS TREE
⊙	CONIFEROUS TREE
■	BITUMINOUS

**CONSTRUCTION LEGEND**

---	GRADING LIMITS
---	5 FT CONTOUR
---	1 FT CONTOUR
○	FENCELINE
☀	LIGHT POLE

**WINTER EROSION CONTROL LEGEND**

▨	CLASS 5 AGGREGATE
▨	EROSION CONTROL BLANKET
▨	OATS COVER CROP

1 PLAN: TEMPORARY WINTER EROSION CONTROL

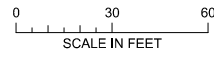

- NOTES:**
- ALL MATERIAL 3" OR LARGER MUST BE REMOVED PRIOR TO SEEDING AND PLACEMENT OF EROSION CONTROL BLANKET.
  - MNDOT OATS COVER CROP SEED MIX 21-111 SHALL BE SEEDING AT A RATE OF 100 POUNDS PER ACRE. INSTALL ACCORDING TO MNDOT 3876. PLACE OVER BARE SOIL, NOT OVER SNOW. REMOVE SNOW AS NECESSARY PRIOR TO SEEDING.
  - COVER OATS COVER CROP SEED WITH EROSION CONTROL BLANKET (CATEGORY 3N2S (EITHER STRAW OR WOOD FIBER)), PLACE OVER BARE SOIL, NOT OVER SNOW. REMOVE SNOW AS NECESSARY PRIOR TO PLACEMENT.
  - ANCHOR EROSION CONTROL BLANKET ON NON-FROZEN GROUND WITH 6 INCH STEEL WIRE PRESSED STRAIGHT INTO THE GROUND WITHOUT BENDING. ANCHOR EROSION CONTROL BLANKET ON FROZEN GROUND WITH 60D (6-INCH) COMMON NAIL WITH WASHER HAMMERED FLUSH WITH ANCHOR FREQUENCY PER MANUFACTURER'S RECOMMENDATIONS.
  - TEMPORARY WINTER EROSION CONTROL SHALL BE IN PLACE NO LATER THAN MARCH 15.
  - REVIEW SWPPP. SEE SHEET SW-01 THROUGH SW-04 FOR ADDITIONAL EROSION CONTROL REQUIREMENTS.

SEE C-12 FOR TEMPORARY WINTER EROSION CONTROL



2 PLAN: ACCESS ROAD TEMPORARY WINTER EROSION CONTROL

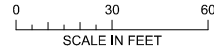

90% DESIGN  
NOT FOR CONSTRUCTION

CADD USER: Kalle J. Turpin-Nigam FILE: I:\DESIGN\2371901_00\2371901_00\2371901_00_C12_TEMP_WINTER_EC.DWG PLOT SCALE: 1:2 PLOT DATE: 4/22/2022 4:34 PM

I HEREBY CERTIFY THAT THIS PLAN, SPECIFICATION, OR REPORT WAS PREPARED BY ME OR UNDER MY DIRECT SUPERVISION AND THAT I AM A DULY LICENSED PROFESSIONAL ENGINEER UNDER THE LAWS OF THE STATE OF MINNESOTA.				
PRINTED NAME	_____			
SIGNATURE	_____			
DATE	_____ LICENSE # _____			

CLIENT	12/18/21	4/22/22					
BID							
CONSTRUCTION							
RELEASED TO/FOR	A	B	C	0	1	2	3
DATE RELEASED							

**BARR** city of golden valley

Corporate Headquarters: Minneapolis, Minnesota Ph: 1-800-632-2277

Scale	AS SHOWN
Date	03/02/2022
Drawn	SZ1
Checked	KJN2
Designed	BARR
Approved	KAL

CITY OF GOLDEN VALLEY  
GOLDEN VALLEY, MN

MEDLEY PARK STORMWATER IMPROVEMENT		BARR PROJECT No. 23/27-1901.00	
TEMPORARY WINTER EROSION CONTROL		CLIENT PROJECT No. 20-26	
DWG. No. C-12	REV. No. B		



**5.0 PERMANENT STORMWATER MANAGEMENT SYSTEM:**

A PERMANANT STORMWATER MANAGEMENT SYSTEM IS REQUIRED IF THE PROJECT RESULTS IN ONE ACRE OR MORE OF NEW IMPERVIOUS SURFACES OR RESULTS IN A NET INCREASE OF ONE OR MORE ACRES OF CUMMULATIVE NEW IMPERVIOUS SURFACES IN TOTAL OR IF THE PROJECT IS PART OF A LARGER PLAN OF DEVELOPMENT. (CSW PERMIT ITEM 15.3)

5.1 A PERMANENT STORMWATER TREATMENT SYSTEM IS NOT REQUIRED. (CSW PERMIT ITEMS 5.15, 15.4-15.9, AND 23.14)

5.2 THIS IS NOT A LINEAR PROJECT WITH LACK OF RIGHT OR WAY. (CSW PERMIT ITEM 15.9)

5.3 THIS PROJECT DOES NOT DISCHARGE TO A TROUT STREAM (OR A TRIBUTARY TO A TROUT STREAM). (CSW PERMIT ITEM 23.12)

**6.0 INSPECTION AND MAINTENANCE ACTIVITIES:**

6.1 PERSONS WITH REQUIRED TRAINING: TRAINED INDIVIDUALS INCLUDE THOSE PARTIES RESPONSIBLE FOR INSTALLING, SUPERVISING, REPAIRING, INSPECTING, AND MAINTAINING EROSION PREVENTION AND SEDIMENT CONTROL BMPS AT THE SITE. TRAINED INDIVIDUALS ARE ALSO RESPONSIBLE FOR IMPLEMENTATION OF THE SWPPP AND COMPLIANCE WITH THE GENERAL PERMIT UNTIL THE CONSTRUCTION ACTIVITIES ARE COMPLETE, PERMANENT COVER HAS BEEN ESTABLISHED, AND A NOTICE OF TERMINATION (NOT) HAS BEEN SUBMITTED. (CSW PERMIT ITEMS 5.20, 5.21, AND 11.9 AND SECTION 21)

THESE INDIVIDUALS WILL BE TRAINED IN ACCORDANCE WITH THE REQUIREMENTS OF THE GENERAL PERMIT, INCLUDING THE REQUIREMENT THAT THE CONTENT AND EXTENT OF TRAINING WILL BE COMMENSURATE WITH THE INDIVIDUAL'S JOB DUTIES AND RESPONSIBILITIES.

BELOW IS A LIST OF PEOPLE RESPONSIBLE FOR THIS PROJECT WHO ARE KNOWLEDGEABLE AND EXPERIENCED IN THE APPLICATION OF EROSION PREVENTION AND SEDIMENT CONTROL BMPS.

TRAINED INDIVIDUAL	RESPONSIBILITY	TRAINING ENTITY*	TRAINING DATE
ALEC BATEMAN	PREPARATION OF THE SWPPP	UNIVERSITY OF MINNESOTA	APRIL, 2021
TBD	OVERSIGHT OF SWPPP IMPLEMENTATION, REVISION, AND AMMENDMENT	TBD	TBD
TBD	PERFORMANCE OF SWPPP INSPECTIONS	TBD	TBD
TBD	PERFORMANCE OR SUPERVISION OF INSTALLATION, MAINTENANCE, AND REPAIR OF BMPS	TBD	TBD

*TRAINING DOCUMENTATION AVAILABLE UPON REQUEST.

6.2 FREQUENCY OF INSPECTIONS: A TRAINED PERSON WILL ROUTINELY INSPECT THE ENTIRE CONSTRUCTION SITE. (CSW PERMIT ITEMS 11.2, 11.10, AND 23.13)

- AT LEAST ONCE EVERY 7 DAYS DURING ACTIVE CONSTRUCTION
- WITHIN 24 HOURS AFTER A RAINFALL EVENT GREATER THAN 0.5 INCHES IN 24 HOURS

INSPECTION FREQUENCY MAY BE ADJUSTED UNDER THE FOLLOWING CIRCUMSTANCES:

- WHERE PARTS OF THE CONSTRUCTION AREAS HAVE PERMANENT COVER, BUT WORK REMAINS ON OTHER PARTS OF THE SITE, INSPECTIONS OF THE AREAS WITH PERMANENT COVER MAY BE REDUCED TO ONCE PER MONTH.
- WHERE CONSTRUCTION AREAS HAVE PERMANENT COVER AND NO CONSTRUCTION ACTIVITY IS OCCURRING ON THE SITE, INSPECTIONS CAN BE REDUCED TO ONCE PER MONTH AND, AFTER 12 MONTHS, MAY BE SUSPENDED COMPLETELY UNTIL CONSTRUCTION ACTIVITY RESUMES.
- WHERE CONSTRUCTION ACTIVITY HAS BEEN SUSPENDED DUE TO FROZEN GROUND CONDITIONS, THE INSPECTIONS MAY BE SUSPENDED. THE REQUIRED INSPECTIONS AND MAINTENANCE SCHEDULE MUST BEGIN WITHIN 24 HOURS AFTER RUNOFF OCCURS AT THE SITE OR UPON RESUMING CONSTRUCTION, WHICHEVER COMES FIRST.

6.3 INSPECTION REQUIREMENTS: EACH CONSTRUCTION STORMWATER SITE INSPECTION WILL INCLUDE INSPECTION OF THE FOLLOWING AREAS: (CSW PERMIT ITEMS 11.3 THROUGH 11.8)

- ALL EROSION PREVENTION AND SEDIMENT CONTROL BMPS AND POLLUTION PREVENTION MANAGEMENT MEASURES
- SURFACE WATERS FOR EVIDENCE OF EROSION AND SEDIMENT DEPOSITION
- CONSTRUCTION SITE VEHICLE EXIT LOCATIONS FOR EVIDENCE OF OFFSITE SEDIMENT TRACKING
- STREETS AND OTHER AREAS ADJACENT TO THE PROJECT FOR EVIDENCE OF OFF SITE ACCUMULATIONS OF SEDIMENT

6.4 MAINTENANCE REQUIREMENTS: MAINTENANCE OF THE FOLLOWING AREAS AND BMPS WILL BE PERFORMED AS FOLLOWS: (CSW PERMIT ITEMS 11.3 THROUGH 11.8)

- NONFUNCTIONAL BMPS WILL BE REPAIRED, REPLACED, OR SUPPLEMENTED WITH FUNCTIONAL BMPS BY THE END OF THE NEXT BUSINESS DAY AFTER DISCOVERY OR AS SOON AS FIELD CONDITIONS ALLOW ACCESS.
- PERIMETER CONTROL DEVICES WILL BE REPAIRED, REPLACED, OR SUPPLEMENTED WHEN THEY BECOME NONFUNCTIONAL OR THE SEDIMENT REACHES 1/2 OF THE HEIGHT OF THE DEVICE.
- TEMPORARY AND PERMANENT SEDIMENTATION BASINS WILL BE DRAINED AND THE SEDIMENT REMOVED WHEN THE DEPTH OF SEDIMENT COLLECTED IN THE BASIN REACHES 1/2 THE STORAGE VOLUME.
- DELTA AND SEDIMENT DEPOSITED IN SURFACE WATERS WILL BE REMOVED, AND THE AREAS WHERE SEDIMENT REMOVAL RESULTS IN EXPOSED SOIL WILL BE RE-STABILIZED. THE REMOVAL AND STABILIZATION WILL BE COMPLETED WITHIN 7 CALENDAR DAYS OF DISCOVERY UNLESS PRECLUDED BY LEGAL, REGULATORY, OR PHYSICAL ACCESS CONSTRAINTS. IF PRECLUDED DUE TO ACCESS CONSTRAINTS, REASONABLE EFFORTS TO OBTAIN ACCESS WILL BE USED. REMOVAL AND STABILIZATION WILL TAKE PLACE WITHIN 7 CALENDAR DAYS OF OBTAINING ACCESS.
- TRACKED SEDIMENT ON PAVED SURFACES WILL BE REMOVED WITHIN 1 CALENDAR DAY OF DISCOVERY.
- AREAS UNDERGOING STABILIZATION WILL BE RESTABILIZED AS NECESSARY TO ACHIEVE REQUIRED COVER.

6.5 RECORDKEEPING REQUIREMENTS: (CSW PERMIT ITEMS 11.11 AND 24.5 AND SECTIONS 6 AND 20)

- ALL INSPECTIONS AND MAINTENANCE ACTIVITIES WILL BE RECORDED IN WRITING WITHIN 24 HOURS OF BEING CONDUCTED AND THESE RECORDS WILL BE RETAINED WITH THE SWPPP. RECORDS OF EACH INSPECTION AND MAINTENANCE ACTIVITY WILL INCLUDE THE DATE AND TIME; NAME OF INSPECTOR(S); FINDINGS OF INSPECTIONS; CORRECTIVE ACTIONS (INCLUDING DATES, TIMES, AND PARTY COMPLETING MAINTENANCE ACTIVITIES); AND

DATE OF ALL RAINFALL EVENTS GREATER THAN 0.5 INCHES IN 24 HOURS AND THE AMOUNT OF RAINFALL FOR EACH EVENT.

- IF ANY DISCHARGE IS OBSERVED DURING THE INSPECTION, THE LOCATION AND APPEARANCE OF THE DISCHARGE (I.E., COLOR, ODOR, SETTLED OR SUSPENDED SOLIDS, OIL SHEEN, AND OTHER OBVIOUS INDICATORS OF POLLUTANTS) WILL BE DOCUMENTED AND A PHOTOGRAPH WILL BE TAKEN.
- THE SWPPP WILL BE AMENDED TO INCLUDE ADDITIONAL OR MODIFIED BMPS TO CORRECT PROBLEMS OR ADDRESS SITUATIONS WHENEVER THERE IS A CHANGE IN DESIGN, CONSTRUCTION, OPERATION, MAINTENANCE, WEATHER, OR SEASONAL CONDITIONS THAT HAS A SIGNIFICANT EFFECT ON THE DISCHARGE OF POLLUTANTS TO SURFACE WATERS OR GROUNDWATER.
    - THE SWPPP WILL BE AMENDED WHEN INSPECTIONS OR INVESTIGATIONS BY THE SITE OWNER, OPERATOR, OR CONTRACTORS OR BY USEPA/MPCA OFFICIALS INDICATE THAT THE SWPPP IS NOT EFFECTIVE IN ELIMINATING OR MINIMIZING THE DISCHARGE OF POLLUTANTS TO SURFACE WATERS OR GROUNDWATER; THE DISCHARGES ARE CAUSING WATER QUALITY STANDARD EXCEEDANCES; OR THE SWPPP IS NOT CONSISTENT WITH A USEPA APPROVED TMDL.
    - ANY AMENDMENTS TO THE SWPPP PROPOSED AS A RESULT OF THE INSPECTION WILL BE DOCUMENTED AS REQUIRED WITHIN 7 CALENDAR DAYS.
    - AMENDMENTS WILL BE COMPLETED BY AN APPROPRIATELY TRAINED INDIVIDUAL. CHANGES INVOLVING THE USE OF A LESS STRINGENT BMP WILL INCLUDE A JUSTIFICATION DESCRIBING HOW THE REPLACEMENT BMP IS EFFECTIVE FOR THE SITE CHARACTERISTICS.
  - RECORDS RETENTION: THE SWPPP, INCLUDING ALL CHANGES TO IT, AND INSPECTION AND MAINTENANCE RECORDS WILL BE KEPT AT THE SITE DURING CONSTRUCTION BY THE PERMITTEE WHO HAS OPERATIONAL CONTROL OF THE SITE. THE SWPPP CAN BE KEPT IN EITHER A FIELD OFFICE OR IN AN ON SITE VEHICLE DURING NORMAL WORKING HOURS.
  - RECORD AVAILABILITY: THE PERMITTEES WILL MAKE THE SWPPP, INCLUDING INSPECTION REPORTS, MAINTENANCE RECORDS, AND TRAINING RECORDS, AVAILABLE TO FEDERAL, STATE, AND LOCAL OFFICIALS WITHIN THREE DAYS UPON REQUEST FOR THE DURATION OF THE PERMIT COVERAGE AND FOR THREE YEARS FOLLOWING THE NOTICE OF TERMINATION.

**7.0 POLLUTION PREVENTION MEASURES:**

- ANY CONSTRUCTION PRODUCTS AND LANDSCAPE MATERIALS THAT HAVE THE POTENTIAL TO LEACH POLLUTANTS WILL BE STORED UNDER COVER (E.G., PLASTIC SHEETING OR TEMPORARY ROOFS) TO PREVENT DISCHARGE OF POLLUTANTS THROUGH MINIMIZATION OF CONTACT WITH STORMWATER. STORAGE OF SUCH MATERIALS WITHIN THE PROJECT AREA WILL BE MINIMIZED TO THE EXTENT POSSIBLE. (CSW PERMIT ITEM 12.2)
- PESTICIDES, FERTILIZERS, AND TREATMENT CHEMICALS WILL BE STORED UNDER COVER (E.G., PLASTIC SHEETING, TEMPORARY ROOFS, WITHIN A BUILDING, OR IN WEATHER-PROOF CONTAINERS) TO PREVENT DISCHARGE OF POLLUTANTS THROUGH MINIMIZATION OF CONTACT WITH STORMWATER. STORAGE OF SUCH MATERIALS WITHIN THE PROJECT AREA WILL BE MINIMIZED TO THE EXTENT POSSIBLE. (CSW PERMIT ITEM 12.3)
- HAZARDOUS MATERIALS AND TOXIC WASTE (E.G., OIL, DIESEL FUEL, GASOLINE, HYDRAULIC FLUIDS, PAINT SOLVENTS, PETROLEUM-BASED PRODUCTS, WOOD PRESERVATIVES, ADDITIVES, CURING COMPOUNDS, AND ACIDS) WILL BE STORED AND DISPOSED OF IN COMPLIANCE WITH MINNESOTA RULES CHAPTER 7045, INCLUDING SECONDARY CONTAINMENT (AS APPLICABLE). HAZARDOUS MATERIALS WILL BE PROPERLY STORED IN SEALED CONTAINERS TO PREVENT SPILLS, LEAKS, OR OTHER DISCHARGES AND PREVENT PRECIPITATION FROM FALLING ONTO THE CONTAINERS OR STORED HAZARDOUS MATERIALS. (CSW PERMIT ITEMS 2.3 AND 12.4)
- SOLID WASTE WILL BE COLLECTED, STORED, AND DISPOSED OF PROPERLY IN COMPLIANCE WITH MINNESOTA RULES CHAPTER 7035. THIS INCLUDES STORAGE WITHIN COVERED TRASH CONTAINERS AND DAILY REMOVAL OF LITTER AND DEBRIS. STORAGE OF SOLID WASTE WITHIN THE PROJECT AREA WILL BE MINIMIZED TO THE EXTENT POSSIBLE. (CSW PERMIT ITEM 12.5)
- PORTABLE TOILETS WILL BE LOCATED AWAY FROM SURFACE WATERS AND POSITIONED AND SECURED TO THE GROUND SO THEY WILL NOT BE TIPPED OR KNOCKED OVER. SANITARY WASTE WILL BE DISPOSED OF IN ACCORDANCE WITH MINNESOTA RULES, CHAPTER 7041. PORTABLE TOILETS WILL BE PERIODICALLY EMPTIED AND THE WASTE HAULED OFF-SITE BY A LICENSED HAULER. (CSW PERMIT ITEM 12.6)
- VEHICLE FUELING WILL ONLY OCCUR IN DESIGNATED AREAS. SPILL KITS SIZED APPROPRIATELY FOR THE AMOUNT OF REFUELING TAKING PLACE WILL BE LOCATED. SPILL KITS WILL BE CLEARLY LABELED AND CONTAIN MATERIALS TO ASSIST IN SPILL CLEANUP INCLUDING ABSORBENT PADS, BOOMS FOR CONTAINING SPILLS, AND HEAVY-DUTY PROTECTIVE GLOVES. SPILLS WILL BE REPORTED TO THE MINNESOTA DUTY OFFICER AS REQUIRED BY MINNESOTA STATUTES, SECTION 115.061. (CSW PERMIT ITEMS 2.3 AND 12.7)
  - ANY FUEL TANKS BROUGHT ON-SITE WILL HAVE PROPERLY SIZED CONTAINMENT AND WILL NOT BE TOPPED OFF TO AVOID SPILLS FROM OVERFILLING. FUEL TANKS WILL MEET INDUSTRY STANDARDS (DESIGNED TO HOLD FUEL TYPE, PROPERLY MAINTAINED, NOT ILLEGALLY MODIFIED, NOT MISSING LEAK INDICATOR FLOATS FOR DOUBLE WALLED TANKS, SIGHT GAUGES NOT USED, ETC.) OR BE REMOVED FROM THE WORK AREA.
  - GUIDELINES FOR SPILL PREVENTION AND RESPONSE INCLUDE:
    - TAKE REASONABLE STEPS TO PREVENT THE DISCHARGE OF SPILLED OR LEAKED CHEMICALS, INCLUDING FUEL, FROM ANY AREA WHERE CHEMICALS OR FUEL WILL BE LOADED OR UNLOADED, INCLUDING THE USE OF DRIP PANS OR ABSORBENTS UNLESS INFEASIBLE;
    - PERFORM REGULAR PREVENTATIVE MAINTENANCE ON TANKS AND FUEL LINES;
    - INSPECT PUMPS, CYLINDERS, HOSES, VALVES, AND OTHER MECHANICAL EQUIPMENT ON-SITE FOR DAMAGE OR DETERIORATION;
    - DO NOT WASH OR RINSE FUELING AREAS WITH WATER;
    - MAINTAIN ADEQUATE SUPPLIES TO CLEAN UP DISCHARGED MATERIALS AND PROVIDE AN APPROPRIATE DISPOSAL METHOD FOR RECOVERED SPILLED MATERIALS;
    - REPORT AND CLEAN UP SPILLS IMMEDIATELY AS REQUIRED BY MINNESOTA STATUTES, SECTION 115.061, USING DRY CLEAN UP MEASURES WHERE POSSIBLE; AND
    - MAINTAIN COPIES OF SAFETY DATA SHEETS (SDSS) FOR HAZARDOUS MATERIALS ON-SITE IN LOCATIONS READILY AVAILABLE TO EMERGENCY RESPONDERS.
- IF VEHICLE AND EQUIPMENT WASHING IS NECESSARY, A VEHICLE WASH STATION WILL BE LOCATED IN A DESIGNATED AREA. RUNOFF FROM THE WASHING AREA WILL BE CONTAINED IN A SEDIMENT BASIN AND WASTE FROM THE WASHING ACTIVITY WILL BE PROPERLY DISPOSED OF. ANY SOAPS, DETERGENTS, OR SOLVENTS WILL BE PROPERLY USED AND STORED. ANY DETERGENTS AND OTHER CLEANERS NOT PERMITTED FOR DISCHARGE WILL NOT BE USED. (CSW PERMIT ITEMS 2.3 AND 12.8)
- THE PROJECT WILL NOT RESULT IN CONCRETE OR OTHER WASHOUT ACTIVITIES. IF NECESSARY, A DESCRIPTION OF THE STORAGE AND DISPOSAL OF CONCRETE AND OTHER WASHOUT WASTES SO THAT WASTES DO NOT CONTACT THE GROUND WILL BE ADDED. (CSW PERMIT ITEMS 2.3 AND 12.9)

**8.0 PERMANENT COVER AND PERMIT TERMINATION CONDITIONS:**

- THE AREAS DISTURBED DURING CONSTRUCTION WILL BE STABILIZED WITH PERMANENT COVER UPON COMPLETION OF WORK. PERMANENT COVER MAY BE VEGETATIVE OR NON-VEGETATIVE, AS APPROPRIATE. ESTABLISHMENT OF PERMANENT COVER MAY INCLUDE THE FOLLOWING ACTIVITIES: A COMBINATION OF SEEDING, MULCHING, EROSION CONTROL BLANKETS, AND/OR PLACEMENT OF IMPERVIOUS SURFACES. (CSW PERMIT ITEM 5.17)
- FOR A CONSTRUCTION-SITE TO ACHIEVE "PERMANENT COVER", THE FOLLOWING REQUIREMENTS MUST BE

COMPLETED PRIOR TO TERMINATION OF PERMIT COVERAGE: (CSW PERMIT SECTIONS 4 AND 13)

- ALL SOIL DISTURBING CONSTRUCTION ACTIVITIES HAVE BEEN COMPLETED AND PERMANENT COVER HAS BEEN INSTALLED OVER ALL AREAS. VEGETATIVE COVER CONSISTS OF A UNIFORM PERENNIAL VEGETATION WITH A DENSITY OF 70% OF ITS EXPECTED FINAL GROWTH. VEGETATION IS NOT REQUIRED WHERE THE FUNCTION OF A SPECIFIC AREA DICTATES NO VEGETATION (SUCH AS IMPERVIOUS SURFACES OR THE BASE OF A SAND FILTER).
- ALL SEDIMENT HAS BEEN REMOVED FROM CONVEYANCE SYSTEMS, INCLUDING CULVERTS.
- ALL TEMPORARY SYNTHETIC EROSION PREVENTION AND SEDIMENT CONTROL BMPS HAVE BEEN REMOVED. BMPS DESIGNED TO DECOMPOSE ON-SITE MAY BE LEFT IN PLACE.

WITHIN 30 DAYS AFTER THE TERMINATION CONDITIONS ARE COMPLETE, A NOTICE OF TERMINATION (NOT) FORM WILL BE SUBMITTED TO THE MPCA.

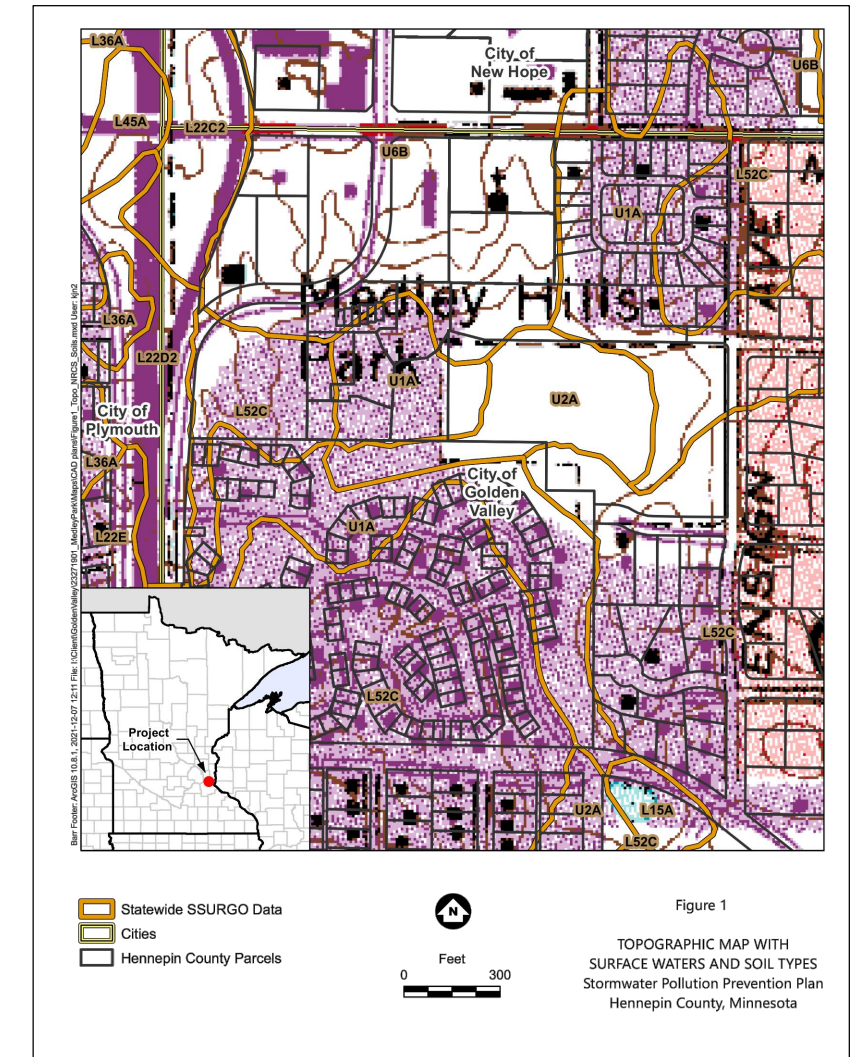

90% DESIGN  
NOT FOR CONSTRUCTION

NO.	BY	CHK	APP.	DATE	REVISION DESCRIPTION
B	GKN	KJN2	KAL	04/22/2022	ISSUED FOR 90% DESIGN REVIEW
A	ADB2	KJN2	KAL	12/10/2021	ISSUED FOR REVIEW

I HEREBY CERTIFY THAT THIS PLAN, SPECIFICATION, OR REPORT WAS PREPARED BY ME OR UNDER MY DIRECT SUPERVISION AND THAT I AM A DULY LICENSED PROFESSIONAL ENGINEER UNDER THE LAWS OF THE STATE OF MINNESOTA.

PRINTED NAME: _____  
SIGNATURE: _____  
DATE: _____ LICENSE # _____

CLIENT	DATE	DATE	DATE	DATE	DATE	DATE	DATE
BID	12/10/21	04/22/22					
CONSTRUCTION							
RELEASED TO/FOR	A	B	C	0	1	2	3
DATE RELEASED							

**BARR** city of golden valley  
Corporate Headquarters: Minneapolis, Minnesota  
Ph: 1-800-632-2277

Scale	AS SHOWN
Date	04/22/2022
Drawn	ADB2
Checked	KJN2
Designed	BARR
Approved	KAL

CITY OF GOLDEN VALLEY  
GOLDEN VALLEY, MN

MEDLEY PARK  
STORMWATER IMPROVEMENT  
STORM WATER POLLUTION PREVENTION PLAN  
(SWPPP) PAGE 2 OF 2

BARR PROJECT No.	23/27-1901.00
CLIENT PROJECT No.	20-26
DWG. No.	SW-02
REV. No.	B



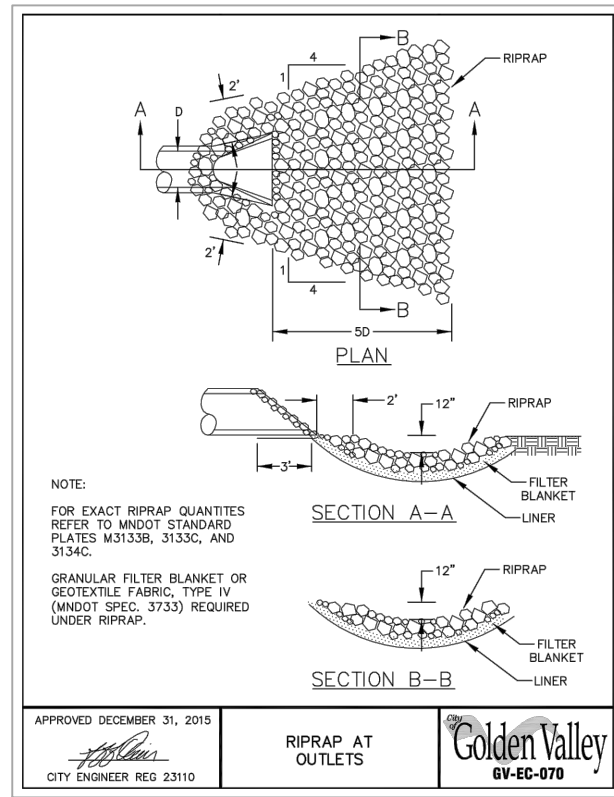

1 DETAIL: RIPRAP AT OUTLETS  
NOT TO SCALE

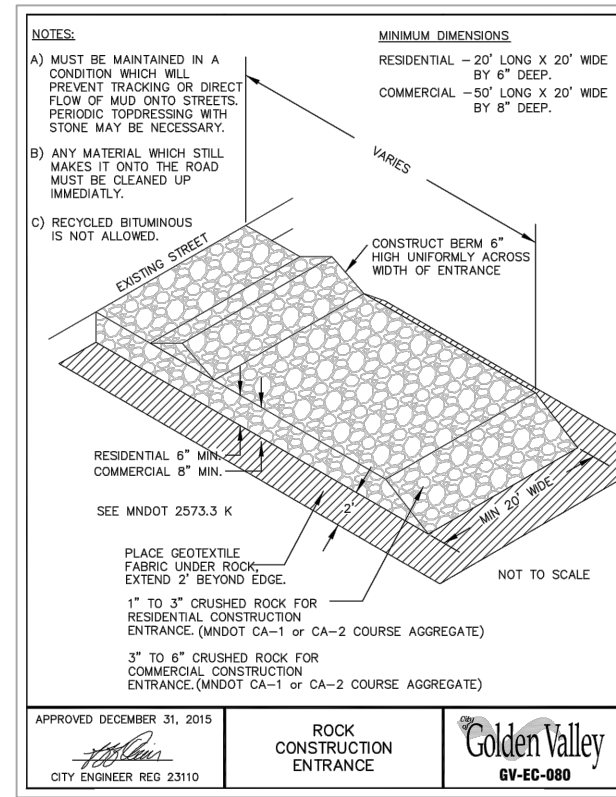

2 DETAIL: ROCK CONSTRUCTION ENTRANCE  
NOT TO SCALE

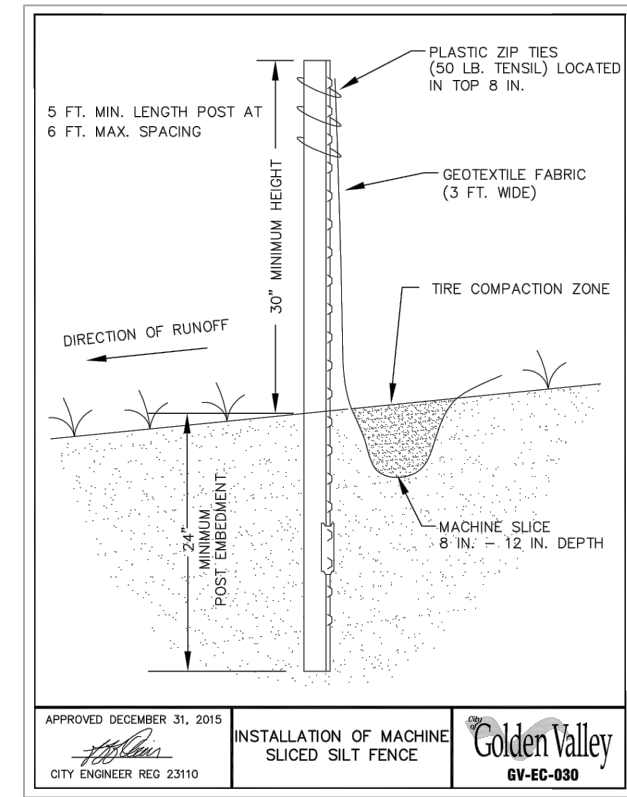

3 DETAIL: MACHINE SLICED SILT FENCE  
NOT TO SCALE

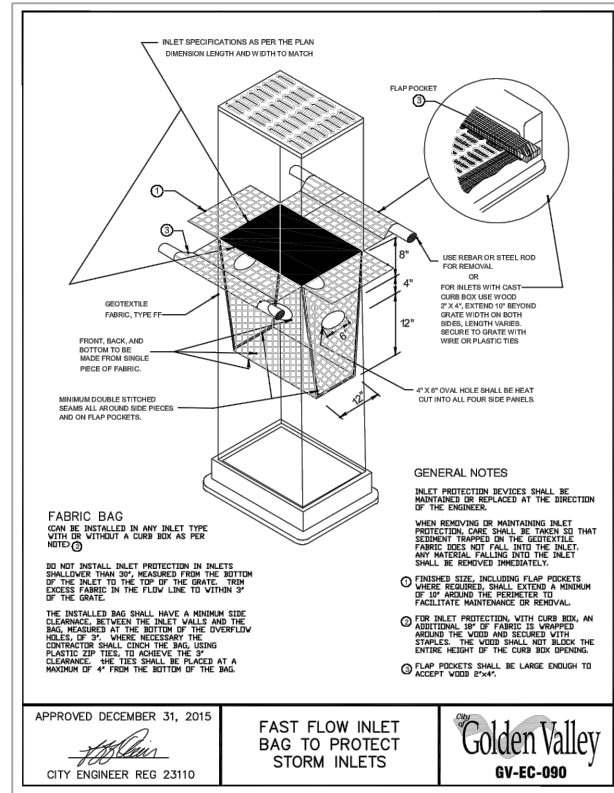

4 DETAIL: INLET PROTECTION  
NOT TO SCALE

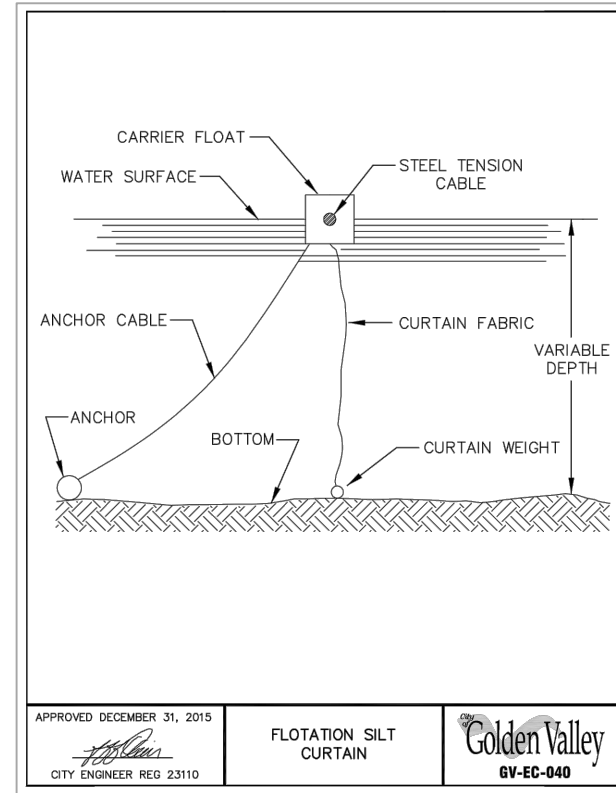

5 DETAIL: FLOTATION SILT CURTAIN  
NOT TO SCALE

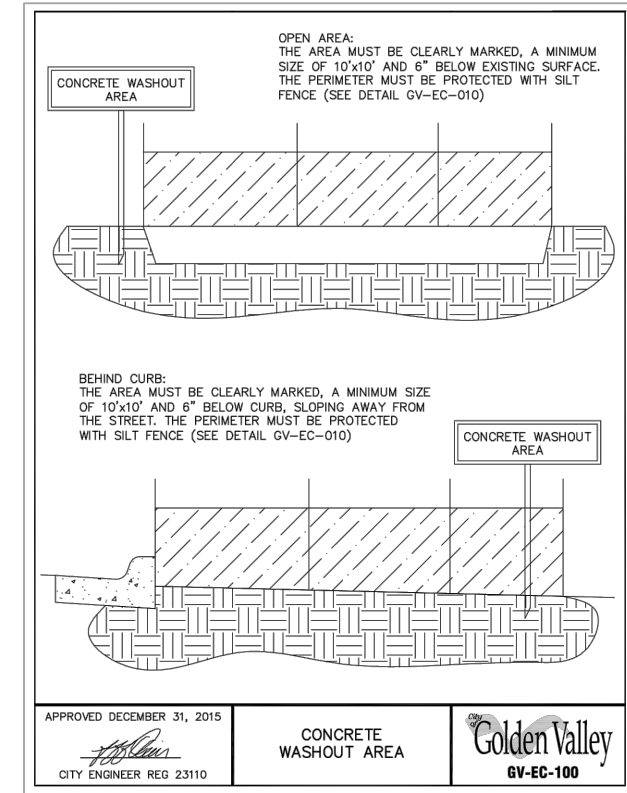

6 DETAIL: CONCRETE WASHOUT AREA  
NOT TO SCALE

CADD USER: Greg Nelson FILE: I:\DESIGN\23271901_003\EROSION CONTROL DETAILS.DWG PLOT SCALE: 1:2 PLOT DATE: 4/22/2022 4:07 PM

NO.	BY	CHK	APP.	DATE	REVISION DESCRIPTION
B	GKN	KJN2	KAL	04/22/2022	ISSUED FOR 90% DESIGN REVIEW
A	ADB2	KJN2	KAL	12/10/2021	ISSUED FOR REVIEW

1 HEREBY CERTIFY THAT THIS PLAN, SPECIFICATION, OR REPORT WAS PREPARED BY ME OR UNDER MY DIRECT SUPERVISION AND THAT I AM A DULY LICENSED PROFESSIONAL ENGINEER UNDER THE LAWS OF THE STATE OF MINNESOTA.

PRINTED NAME: _____  
SIGNATURE: _____  
DATE: _____ LICENSE #: _____

CLIENT	2/10/21	4/22/22					
BID							
CONSTRUCTION							
RELEASED TO/FOR	A	B	C	0	1	2	3
DATE RELEASED							

**BARR** golden valley  
Corporate Headquarters: Minneapolis, Minnesota  
Ph: 1-800-632-2277

Scale	AS SHOWN
Date	04/22/2022
Drawn	ADB2
Checked	KJN2
Designed	BARR
Approved	KAL

CITY OF GOLDEN VALLEY  
GOLDEN VALLEY, MN

**MEDLEY PARK STORMWATER IMPROVEMENT**  
EROSION & SEDIMENT CONTROL  
DETAILS

BARR PROJECT No.	23/27-1901.00
CLIENT PROJECT No.	20-26
DWG. No.	SW-03
REV. No.	B

90% DESIGN  
NOT FOR CONSTRUCTION

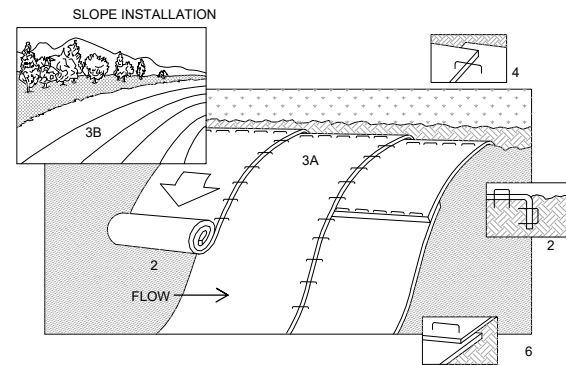

NOTES:

- REFER TO MANUFACTURER RECOMMENDATIONS FOR STAPLE PATTERNS FOR SLOPE INSTALLATIONS.
- PREPARE SOIL BY LOOSENING TOP 1-2 INCHES AND APPLY SEED (AND FERTILIZER WHERE REQUIRED) PRIOR TO INSTALLING BLANKETS. GROUND SHOULD BE SMOOTH AND FREE OF DEBRIS.
- BEGIN (A) AT THE TOP OF THE SLOPE AND ROLL THE BLANKETS DOWN OR (B) AT ONE END OF THE SLOPE AND ROLL THE BLANKETS HORIZONTALLY ACROSS THE SLOPE.
- THE EDGES OF PARALLEL BLANKETS MUST BE STAPLED WITH APPROXIMATELY 6" OVERLAP, WITH THE UPHILL BLANKET ON TOP.
- WHEN BLANKETS MUST BE SPLICED DOWN THE SLOPE, PLACE BLANKETS END OVER END (SHINGLE STYLE) WITH APPROXIMATELY 6" OVERLAP. STAPLE THROUGH OVERLAPPED AREA, APPROXIMATELY 12" APART.
- BLANKET MATERIALS SHALL BE AS SPECIFIED OR AS APPROVED BY ENGINEER.

**1** **DETAIL: EROSION CONTROL BLANKET - INSTALLATION**  
NOT TO SCALE

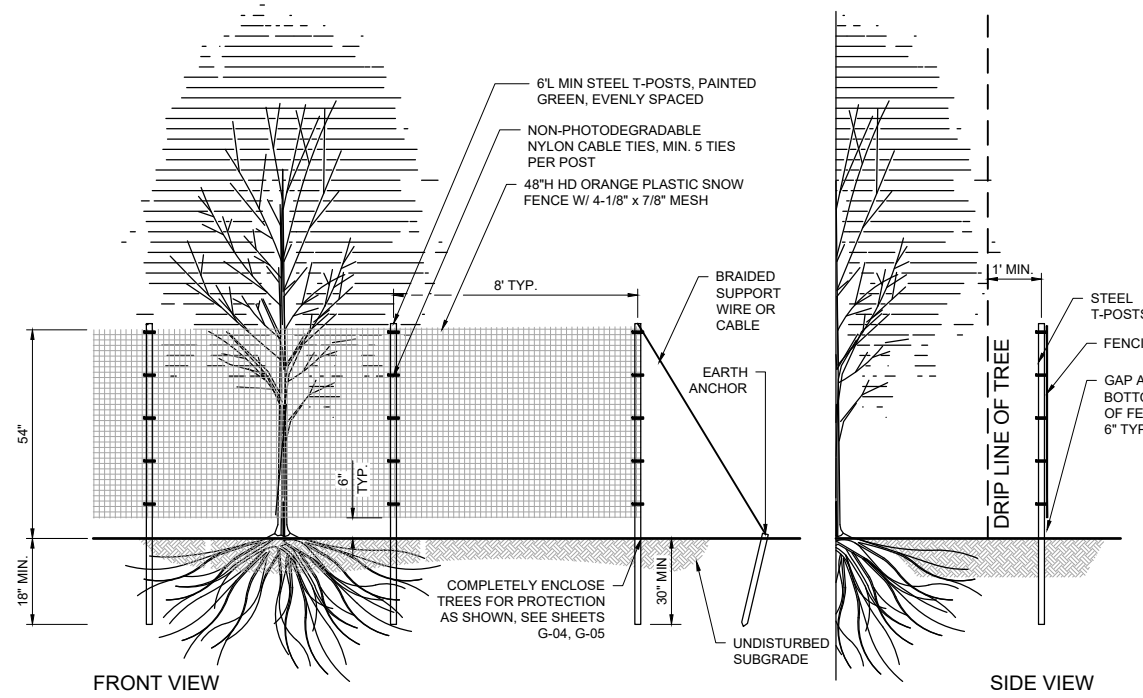

NOTES:

- ENSURE FENCE IS PULLED TAUGHT BETWEEN POSTS AND ANCHOR SECURELY AS SHOWN. ENSURE CABLE TIES ARE PULLED TAUGHT AGAINST POST TO PREVENT SLIPPING.
- PROVIDE 6" TYP. SPACE AT BOTTOM OF FENCE AS SHOWN TO PREVENT SMALL ANIMAL ENTRAPMENT IN FENCED AREA.
- ENSURE CABLE TIES ARE EXTREME WEATHER COLD TEMPERATURE UV STABILIZED TIES.
- T-POSTS SHALL BE STUDD FOR CABLE TIE ATTACHMENT.
- INSPECT FENCE REGULARLY AND REPAIR TO MAINTAIN OR REPLACE AS NECESSARY THROUGHOUT THE TERM OF THE PROJECT.

**2** **DETAIL: TREE PROTECTION FENCE**  
NOT TO SCALE

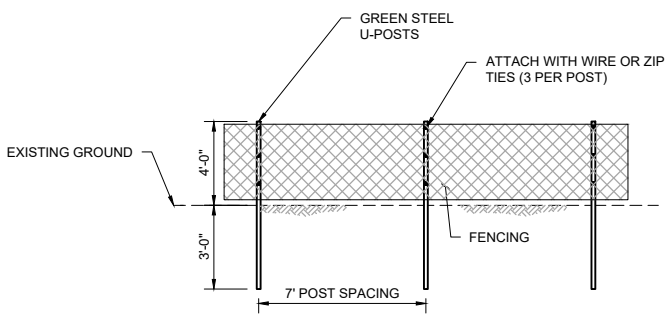

NOTES:

- CONTRACTOR IS RESPONSIBLE FOR MAINTAINING THE FENCE IN AN ORDERLY AND UPRIGHT CONDITION FOR ONE FULL YEAR AFTER INSTALL.
- CONTRACTOR WILL REPAIR FENCE WITHIN 7 DAYS OF NOTIFICATION FROM OWNER OR ENGINEER.

**3** **DETAIL: GREEN CONSTRUCTION FENCE**  
NOT TO SCALE

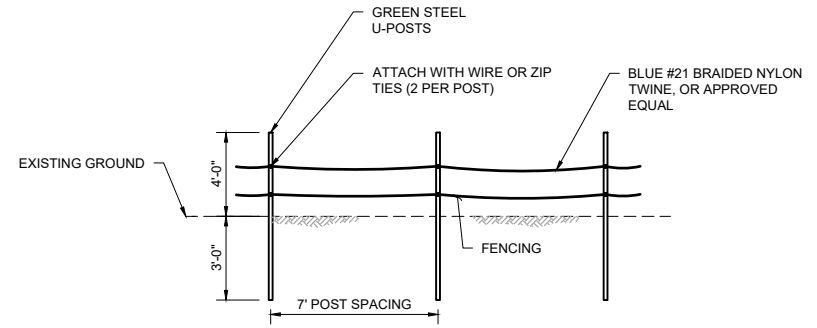

NOTES:

- CONTRACTOR IS RESPONSIBLE FOR MAINTAINING THE FENCE IN AN ORDERLY AND UPRIGHT CONDITION FOR ONE FULL YEAR AFTER INSTALL.
- CONTRACTOR WILL REPAIR FENCE WITHIN 7 DAYS OF NOTIFICATION FROM OWNER OR ENGINEER.

**3** **DETAIL: TWINE GOOSE FENCE**  
NOT TO SCALE

CADD USER: Greg Nelson FILE: M:\DESIGN\23271901_003271901_003271901_S\W04_EROSION CONTROL DETAILS.DWG PLOT SCALE: 1:2 PLOT DATE: 4/22/2022 4:07 PM

90% DESIGN  
NOT FOR CONSTRUCTION

				I HEREBY CERTIFY THAT THIS PLAN, SPECIFICATION, OR REPORT WAS PREPARED BY ME OR UNDER MY DIRECT SUPERVISION AND THAT I AM A DULY LICENSED PROFESSIONAL ENGINEER UNDER THE LAWS OF THE STATE OF MINNESOTA.				CLIENT BID				1/2/2021		4/22/22						Scale AS SHOWN							
				PRINTED NAME _____				CONSTRUCTION												Date 04/22/2022							
				SIGNATURE _____																Drawn ADB2							
				DATE _____ LICENSE # _____				RELEASED TO/FOR				A		B		C				Checked KJN2							
NO.				BY				CHK				APP		DATE		REVISION DESCRIPTION				Designed BARR							
																				Approved KAL							
												Corporate Headquarters: Minneapolis, Minnesota Ph: 1-800-632-2277				CITY OF GOLDEN VALLEY GOLDEN VALLEY, MN				MEDLEY PARK STORMWATER IMPROVEMENT EROSION & SEDIMENT CONTROL DETAILS				BARR PROJECT No. 23/27-1901.00			
																				CLIENT PROJECT No. 20-26				DWG. No. SW-04		REV. No. B	

Concrete Reinforcement Mat Seed Mix			
Common Name	Scientific Name	PLS Rate (lb/ac)	% of Mix (by weight)
Canada Wild Rye	<i>Elymus canadensis</i>	1.50	11.5%
Virginia wild rye	<i>Elymus virginicus</i>	1.50	11.5%
Little Bluestem	<i>Schizachyrium scoparium</i>	3.50	26.9%
Sideoats Grama	<i>Bouteloua curtipendula</i>	4.50	34.6%
Blue Grama	<i>Bouteloua gracilis</i>	2.00	15.4%
<b>Total</b>		<b>13.00</b>	<b>100%</b>

**NOTES:**  
 1. SEEDING MUST BE COMPLETED WHEN PONDS ARE AT NWL  
 2. SEE SHEET L-02 FOR TREE AND SHRUB PLANTING DETAILS.  
 3. LOCATE UNDERGROUND UTILITIES PRIOR TO TREE AND SHRUB PLANTING. NOTIFY ENGINEER OF CONFLICTS WITH UTILITIES. TREE AND SHRUB LOCATIONS WILL BE ADJUSTED IN THE FIELD.  
 4. IMMEDIATELY AFTER SEEDING, NO MORE THAN 12 HOURS, INSTALL HYDRAULIC EROSION CONTROL PRODUCTS (HYDROMULCH), PER MNDOT SPECIFICATION 2575. ALL SEEDING AREAS SHALL UTILIZE HYDROMULCH FOR STABILIZATION UNLESS OTHERWISE NOTED ON THE PLANS, REGARDLESS OF SLOPE, WITH TYPE BONDED FIBER MATRIX (BFM) WITH NATURAL TACKIFIER IN ACCORDANCE WITH MNDOT SPECIFICATION 2575.

**EXISTING CONDITIONS LEGEND**

- NORMAL WATER LEVEL (NWL)
- - - - - STORM SEWER
- - - - - UNDERGROUND ELECTRIC
- ○ ○ ○ ○ FENCELINE
- ☀ LIGHT POLE
- ☪ EXISTING TREE

**CONSTRUCTION LEGEND**

- GRADING LIMITS
- 890 5 FT CONTOUR
- 889 1 FT CONTOUR
- ○ ○ ○ ○ GREEN CONSTRUCTION FENCE (GOOSE FENCE)
- ++++ TWINE GOOSE FENCE

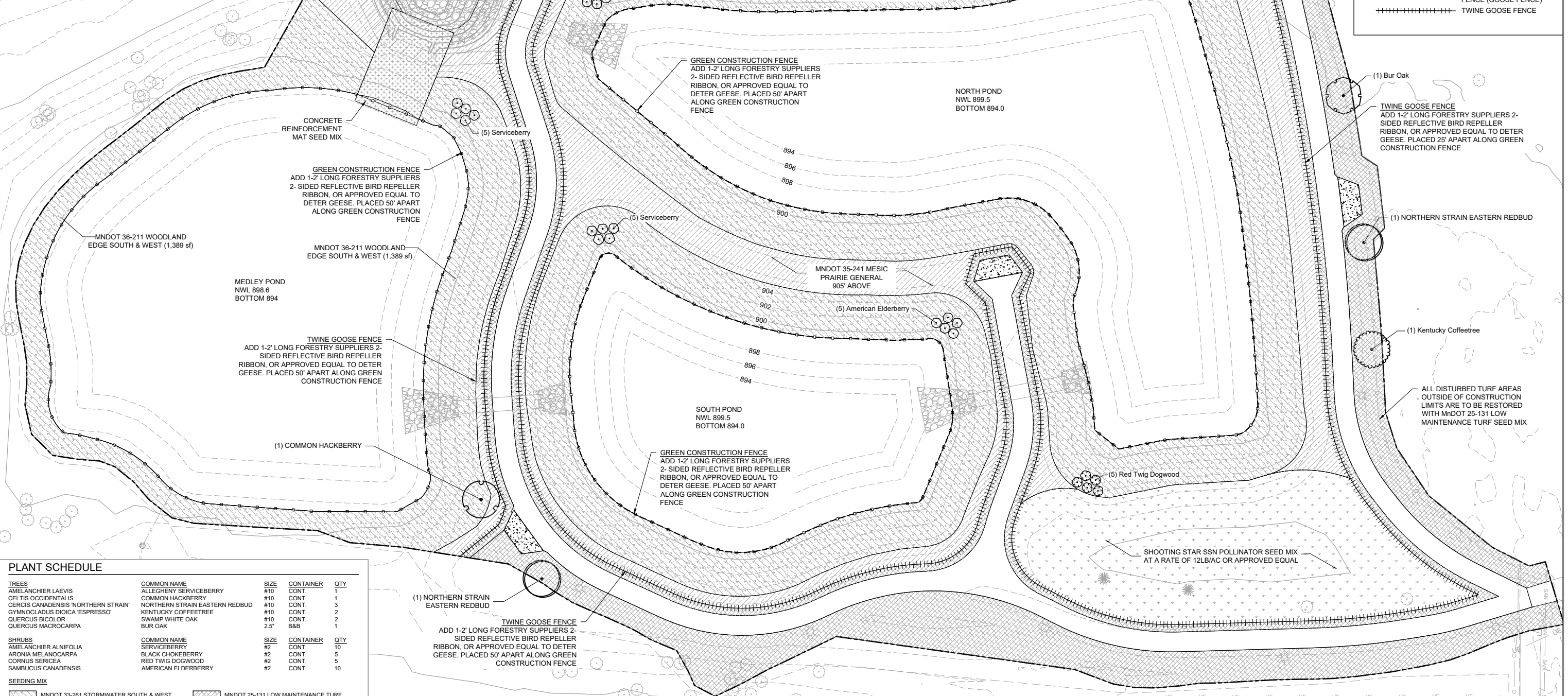

**PLANT SCHEDULE**

TREES	COMMON NAME	SIZE	CONTAINER	QTY
AMELANCHIER LAEVIS	ALLEGHENY SERVICEBERRY	#10	CONT.	1
CELTIS OCCIDENTALIS	COMMON HACKBERRY	#10	CONT.	1
CERCIS CANADENSIS 'NORTHERN STRAIN'	NORTHERN STRAIN EASTERN REDBUD	#10	CONT.	3
GYMNOCLADUS DIOICA 'ESPRESSO'	KENTUCKY COFFEETREE	#10	CONT.	2
QUERCUS BICOLOR	SWAMP WHITE OAK	#10	CONT.	2
QUERCUS MACROCARPA	BUR OAK	25"	B&B	1
SHRUBS	COMMON NAME	SIZE	CONTAINER	QTY
AMELANCHIER ALNIFOLIA	SERVICEBERRY	#2	CONT.	10
ARONIA MELANOCARPA	BLACK CHOKEBERRY	#2	CONT.	5
CORNUS SERICEA	RED TWIG DOGWOOD	#2	CONT.	5
SAMBUCUS CANADENSIS	AMERICAN ELDERBERRY	#2	CONT.	10

**SEEDING MIX**

MNDOT 33-261 STORMWATER SOUTH & WEST	MNDOT 25-131 LOW MAINTENANCE TURF
MNDOT 35-241 MESIC PRAIRIE GENERAL	CONCRETE REINFORCEMENT MAT SEED MIX
MNDOT 36-211 WOODLAND EDGE SOUTH & WEST	SHOOTING STAR SSN POLLINATOR SEED MIX AT A RATE OF 12LB/AC OR APPROVED EQUAL

1 PLAN: LANDSCAPE PLANTING

0 20 40  
SCALE IN FEET

90% DESIGN  
NOT FOR CONSTRUCTION

CADD USER: Greg Nelson FILE: M:\DESIGN\23271901_00\23271901_00_LANDSCAPE PLANTING PLOT SCALE: 1/2" PLOT DATE: 4/22/2022 4:07 PM

NO.	BY	CHK	APP.	DATE	REVISION DESCRIPTION
B	SZ1	KJN2	KAL	4/22/2022	ISSUED FOR 90% DESIGN REVIEW
A	SZ1	KJN2	KAL	12/10/2021	ISSUED FOR REVIEW

I HEREBY CERTIFY THAT THIS PLAN, SPECIFICATION, OR REPORT WAS PREPARED BY ME OR UNDER MY DIRECT SUPERVISION AND THAT I AM A DULY LICENSED PROFESSIONAL ENGINEER UNDER THE LAWS OF THE STATE OF MINNESOTA.

CLIENT: 12/10/21 4/22/22

BID: _____

CONSTRUCTION: _____

RELEASED TO/FOR: A B C 0 1 2 3

DATE RELEASED: _____

PRINTED NAME: _____

SIGNATURE: _____

DATE: _____ LICENSE #: _____

**BARR** golden valley

Corporate Headquarters: Minneapolis, Minnesota Ph: 1-800-632-2277

Scale	AS SHOWN
Date	04/22/2022
Drawn	SZ1
Checked	KJN2
Designed	BARR
Approved	KAL

CITY OF GOLDEN VALLEY  
GOLDEN VALLEY, MN

MEDLEY PARK STORMWATER IMPROVEMENT		BARR PROJECT No. 23/27-1901.00
LANDSCAPE PLANTING PLAN		CLIENT PROJECT No. 20-26
DWG. No. L-01	REV. No. B	

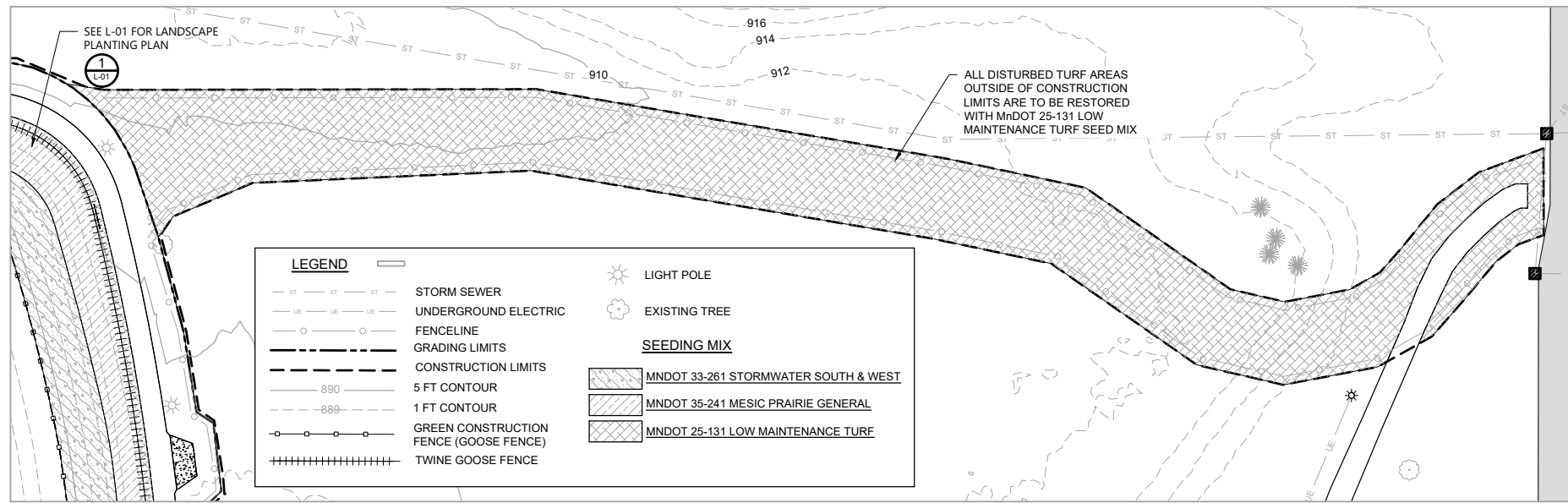

1 PLAN: ACCESS ROAD SEEDING

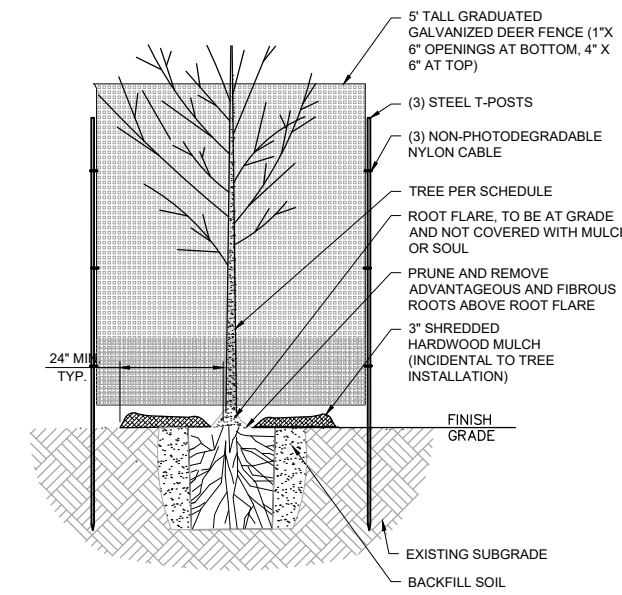

2 DETAIL: TREE PLANTING  
NOT TO SCALE

- TREE PLANTING NOTES:**
1. PROVIDE AND INSTALL PLANTS PER SCHEDULE.
  2. ALL DECIDUOUS TREES SHALL BE ENCLOSED BY GALVANIZED DEER FENCING TO PROTECT FROM ANIMAL BROWSING. TREE PROTECTION SHALL BE CONSIDERED INCIDENTAL TO TREE PLANTING.
  3. REMOVE DEAD OR DAMAGED BRANCHES. RETAIN THE NATURAL FORM OF PLANT. DO NOT CUT THE LEADER.
  4. IF ROOT FLARE IS NOT EXPOSED WITHIN THE CONTAINER EXCAVATE SURFACE SOIL TO BASE OF ROOT FLARE.
  5. DIG PLANT HOLES 6" MIN. LARGER THAN ROOT MASS, ALL SIDES.
  6. SCARIFY BOTTOM AND SIDES OF HOLE PRIOR TO PLANTING.
  7. SET TREE ON LIGHTLY FIRMED BACKFILL SOIL SO ROOT FLARE IS EVEN WITH FINISH GRADE.
  8. BACKFILL WITH PLANTING SOIL AND FIRM SOIL AROUND ROOT MASS TO MAINTAIN PLUMB AND ENSURE NO AIR GAPS AROUND ROOT MASS.
  9. CONSTRUCT 3" WATERING BASIN. THOROUGHLY WATER WITHIN 3 HOURS OF INSTALLATION.
  10. PLACE SHREDDED HARDWOOD MULCH (MNDOT SPEC 3882.2 TYPE 6 - WEED SEED FREE SHREDDED HARDWOOD) TO A RADIUS OF 24" AND TO A DEPTH OF 3" AROUND TREE (SOIL PREPARED AS PER PLAN).
  11. NO MULCH TO BE IN CONTACT WITH BASE OF PLANT.
  12. CONTRACTOR IS RESPONSIBLE FOR MAINTAINING TREES IN A PLUMB POSITION THROUGHOUT THE GUARANTEE PERIOD.
  13. CONTRACTOR TO WATER AS NECESSARY THROUGHOUT GUARANTEE PERIOD TO MAINTAIN IN A HEALTHY CONDITION. AT THE END OF THE GUARANTEE PERIOD ALL TREES THAT ARE DEAD OR DETERMINED UNHEALTHY OR UNSIGHTLY SHALL BE REPLACED AT CONTRACTOR'S EXPENSE. SEE HERBACEOUS PLANT ESTABLISHMENT SPECIFICATIONS FOR ADDITIONAL DETAIL.

- SHRUB PROTECTION NOTES:**
1. CONTRACTOR IS RESPONSIBLE FOR MAINTAINING PROTECTION FENCE THROUGHOUT THE GUARANTEE PERIOD.
  2. CONTRACTOR IS RESPONSIBLE FOR REMOVING FENCING AFTER GUARANTEE PERIOD, OR AS DIRECTED BY OWNER, INSTALL AND REMOVAL IS INCIDENTAL TO COST OF SHRUBS.

- TREE STAKING NOTES:**
1. ALL TREES SHALL BE STAKED AND TIED TO MAINTAIN VERTICALITY FOLLOWING PLANTING. TREE STAKING SHALL BE CONSIDERED INCIDENTAL TO TREE PLANTING.
  2. INSTALL TWO (2) 8' STEEL T-POSTS, ANCHORED 2' INTO THE GROUND ON EITHER SIDE OF THE TRUNK.
  3. INSTALL 16" LONG 40 MIL POLYPROPYLENE OR POLYETHYLENE STRAPS AROUND TRUNK AND AFFIX TO HOLES IN T-POSTS WITH 10 GAUGE WIRE.
  4. REMOVE THE TREE STAKING AFTER TWO (2) YEARS OF MAINTAINED PLUMB POSITION, OR AS DIRECTED BY OWNER, INSTALL AND REMOVAL IS INCIDENTAL TO COST OF TREES.

- NOTES:**
1. PREPARE PLANTING SOIL PER PLAN AND AS SPECIFIED.
  2. PROVIDE AND INSTALL PLANTS PER PLANTING SCHEDULE.
  3. DIG PLANT HOLES 18" MIN. LARGER THAN ROOT MASS, ALL SIDES.
  4. SET SHRUB ON LIGHTLY FIRMED BACKFILL SOIL AT THE SAME DEPTH GROWN IN THE NURSERY.
  5. BACKFILL WITH PLANTING SOIL. FIRM SOIL AROUND ROOT MASS TO MAINTAIN PLUMB AND ENSURE NO AIR GAPS IN SOIL REMAIN.
  6. CONSTRUCT 3" WATERING BASIN. THOROUGHLY WATER WITHIN 3 HOURS OF PLANTING.
  7. PLACE SHREDDED HARDWOOD MULCH (MNDOT SPEC 3882.2 TYPE 6 - WEED SEED FREE SHREDDED HARDWOOD) TO A RADIUS OF 24" AND TO A DEPTH OF 3" AROUND SHRUB (SOIL PREPARED AS PER PLAN).
  8. NO MULCH SHALL BE ALLOWED TO BE IN CONTACT WITH PLANT.
  9. NOTIFY OWNER FOR ALL INSPECTIONS FOR PLANTING AND REPLACEMENTS, AS SPECIFIED.
  10. INSTALL SHRUB PROTECTION FENCE, SEE L-02.

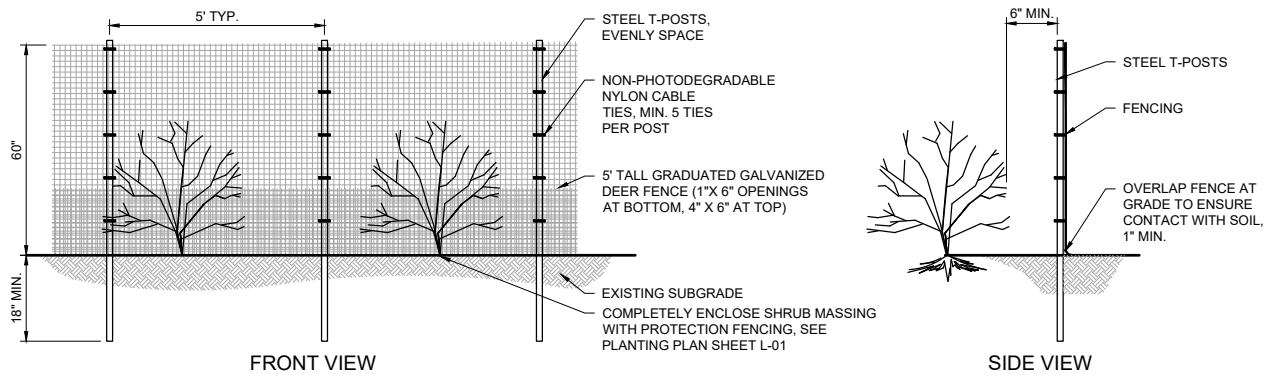

3 DETAIL: SHRUB PROTECTION FENCE  
NOT TO SCALE

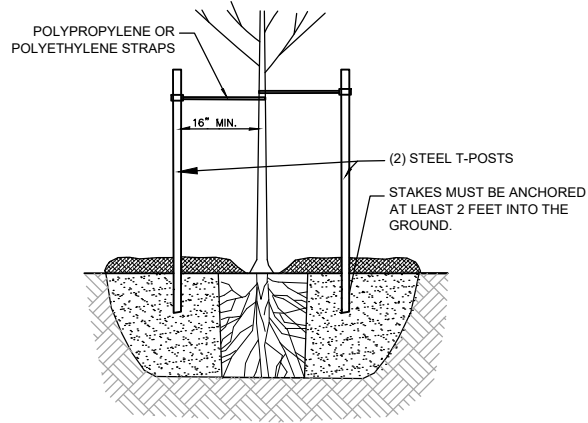

4 DETAIL: TREE STAKING  
NOT TO SCALE

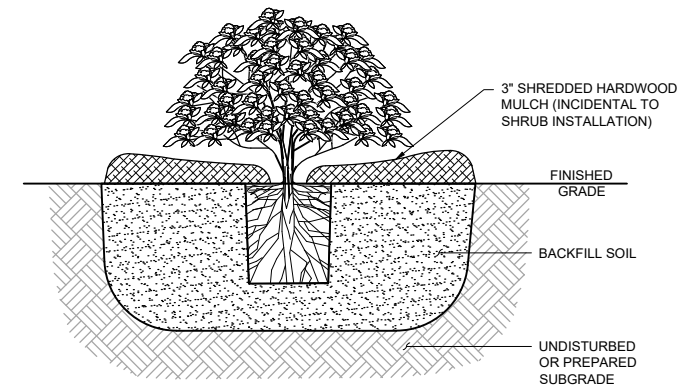

5 DETAIL: SHRUB PLANTING  
NOT TO SCALE

90% DESIGN  
NOT FOR CONSTRUCTION

CADD USER: Greg Nelson FILE: I:\DESIGN\23271901_00\23271901_00_LANDSCAPE PLAN & DETAILS.DWG PLOT SCALE: 1:2 PLOT DATE: 4/22/2022 4:07 PM

I HEREBY CERTIFY THAT THIS PLAN, SPECIFICATION, OR REPORT WAS PREPARED BY ME OR UNDER MY DIRECT SUPERVISION AND THAT I AM A DULY LICENSED PROFESSIONAL ENGINEER UNDER THE LAWS OF THE STATE OF MINNESOTA.				CLIENT BID CONSTRUCTION				12/10/21 4/22/22								Scale AS SHOWN Date 04/22/2022 Drawn SZ1 Checked BHD Designed BARR Approved KAL				CITY OF GOLDEN VALLEY GOLDEN VALLEY, MN				MEDLEY PARK STORMWATER IMPROVEMENT LANDSCAPE PLAN AND DETAILS				BARR PROJECT No. 23/27-1901.00 CLIENT PROJECT No.			
PRINTED NAME SIGNATURE DATE LICENSE #				RELEASED TO/FOR DATE RELEASED				A B C 0 1 2 3				Corporate Headquarters Minneapolis, Minnesota Ph: 1-800-632-2277				DWG. No. L-02 REV. No. B															
NO.	BY	CHK.	APP.	DATE	REVISION DESCRIPTION																										
B	SZ1	KJN2	KAL	4/22/2022	ISSUED FOR 90% DESIGN REVIEW																										
A	SZ1	KJN2	KAL	12/10/2021	ISSUED FOR REVIEW																										

CADD USER: Greg Nelson FILE: I:\DESIGN\03271901_003271901_001_SOIL BORINGS_SED LOGS.DWG PLOT SCALE: 1:2 PLOT DATE: 4/22/2022 4:07 PM

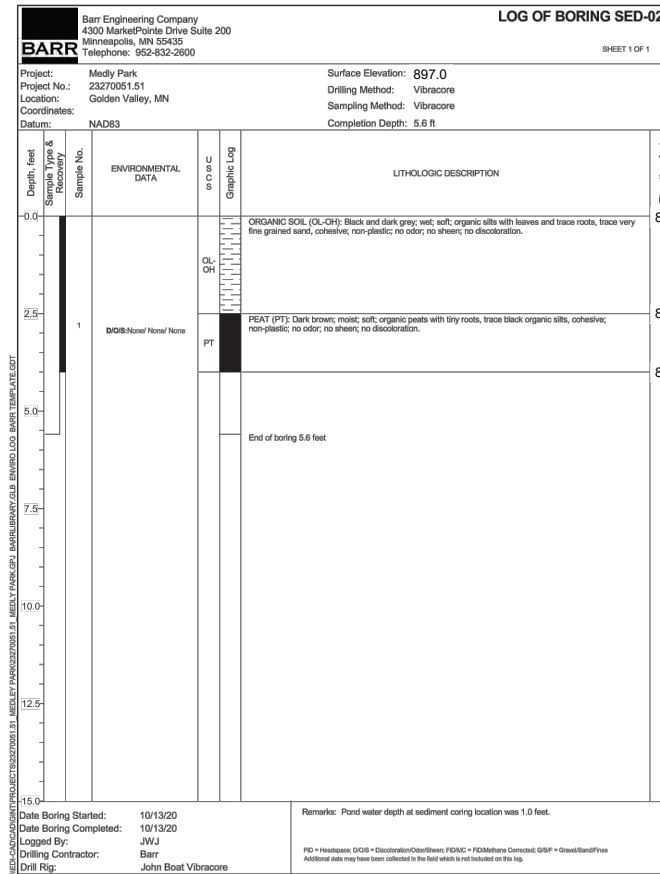
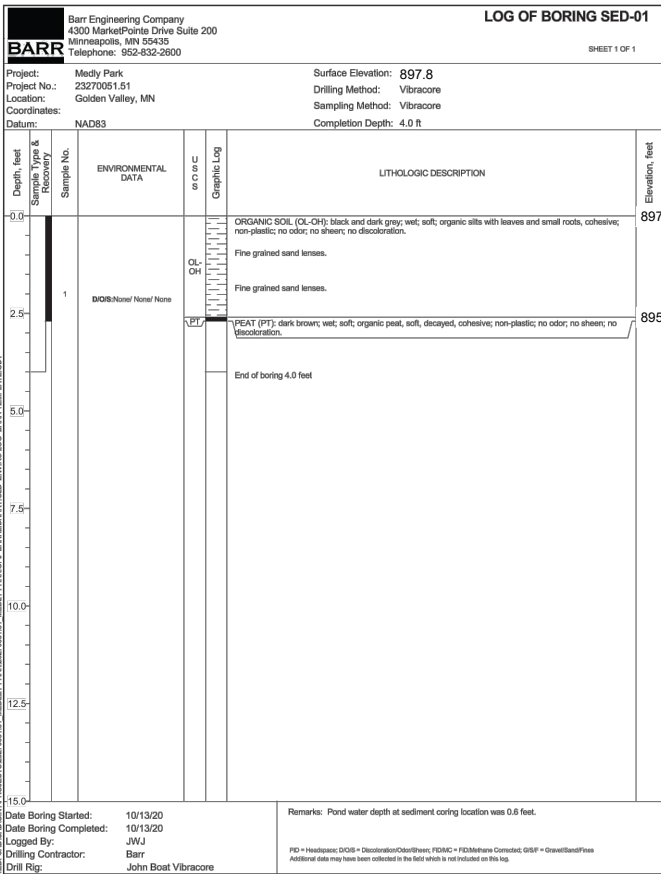
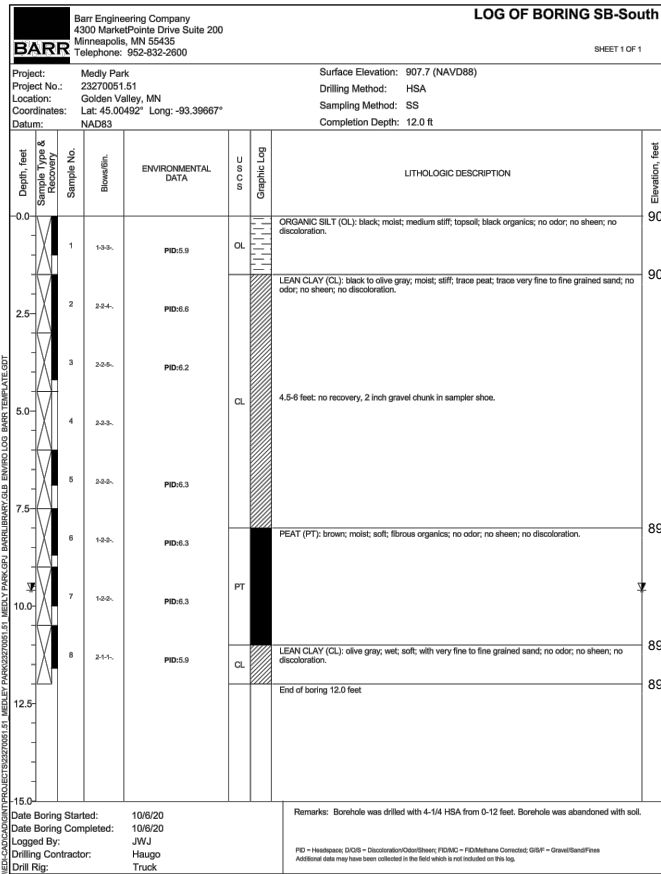
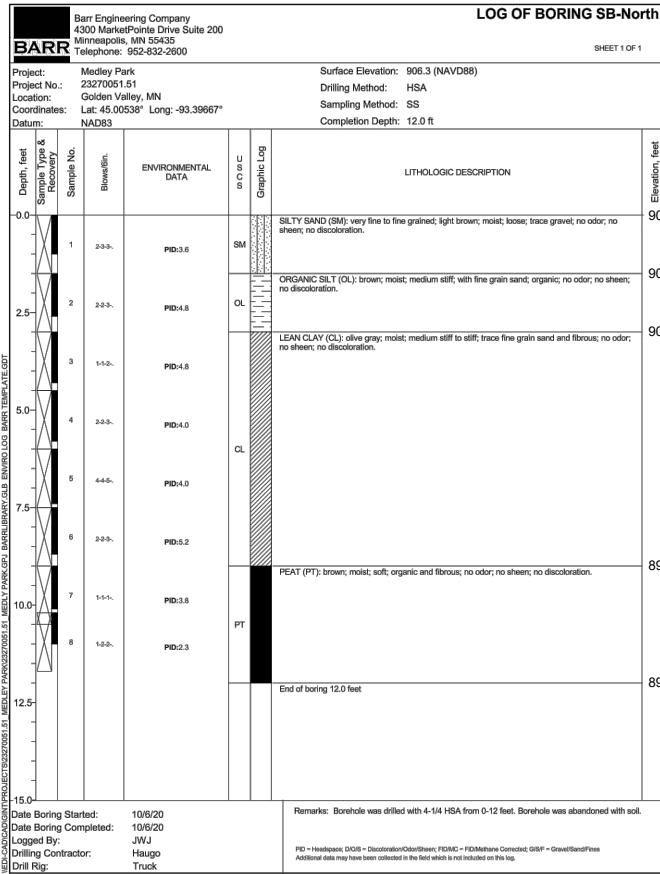

NOTE:  
1) SEE SHEET C-01 FOR SOIL BORING LOCATIONS

90% DESIGN  
NOT FOR CONSTRUCTION

NO.	BY	CHK.	APP.	DATE	REVISION DESCRIPTION
B	GGN	KJN2	KAL	04/22/2022	ISSUED FOR 90% DESIGN REVIEW
A	ADB2	KJN2	KAL	12/10/2021	ISSUED FOR REVIEW

CLIENT	2/10/21	4/22/22						
BID								
CONSTRUCTION								
RELEASED TO/FOR	A	B	C	0	1	2	3	
DATE RELEASED								

I HEREBY CERTIFY THAT THIS PLAN, SPECIFICATION, OR REPORT WAS PREPARED BY ME OR UNDER MY DIRECT SUPERVISION AND THAT I AM A DULY LICENSED PROFESSIONAL ENGINEER UNDER THE LAWS OF THE STATE OF MINNESOTA.

PRINTED NAME: _____  
SIGNATURE: _____  
DATE: _____ LICENSE #: _____

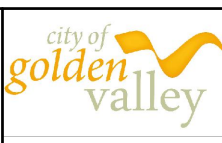

Scale	AS SHOWN
Date	04/22/2022
Drawn	BARR
Checked	KJN2
Designed	BARR
Approved	KAL

CITY OF GOLDEN VALLEY  
GOLDEN VALLEY, MN

MEDLEY PARK  
STORMWATER IMPROVEMENT  
SOIL BORINGS AND SEDIMENT LOGS

BARR PROJECT No.	
23/27-1901.00	
CLIENT PROJECT No.	
20-26	
DWG. No.	REV. No.
B-01	B